



QINGDAO DASHI HUIHAO CASTER CO.,LTD

WhatsApp: +86 15698166560

Email: candy@dsuihao.com

Web: www.dsuihao.com

Address: No. 1 Xingxin Road, Daxin Street, Jimo

District, Qingdao, Shandong

青岛大世汇豪脚轮有限公司

手机: +86 15698166560

传真: 0532-82530710

邮箱: candy@dsuihao.com

网址: www.dsuihao.com

地址: 山东省青岛市即墨区大信街道兴信路1号

Qingdao Dashi Huihao Caster Co.,Ltd
青岛大世汇豪脚轮有限公司



DASHI / 大世
SINCE 2005

*Our goal:
Let China quality casters serve the world.*

大世人有一个梦想：
“让中国精品脚轮服务于世界”



BRAND/品牌

ABOUT DASHI 关于大世

DASHI CASTER SPECIALIZES
IN THE PRODUCTION OF INDUSTRIAL CASTERS

大世脚轮—专注于工业脚轮生产



COMPANY PROFILE

公司简介

Founded in 2005, Dashi Caster is located in Dajinjia Industrial Park, Qingdao City, China and covers an area of 38,000 square meters totally. We employ more than 200 staffs and have production capacity of 40000 casters per day.

Dashi Caster specializes in producing industrial casters and focuses on R&D of different kinds of casters such as heavy duty casters, industrial logistics casters, shock absorbing casters, noise-free casters, leveling casters, grooved casters etc.

In 2016, Qingdao Huihao Caster co., Ltd., a wholly owned subsidiary of Dashi Caster was established and focuses on R&D of high-end caster.

In 2021, with strategic integration, Huihao Caster will be renamed Dashi Huihao Caster.

大世脚轮成立于2005年，位于山东青岛大金家工业园，公司目前占地38000平方米，员工近200人，日产脚轮40000个。

大世脚轮专注生产工业脚轮，致力于研发生产各种规格的重型脚轮、工业物流脚轮、缓冲脚轮、静音脚轮、水平调节轮、轨道轮等。

2016年，成立全资子公司青岛汇豪脚轮有限公司，专注于高端脚轮的研发生产。

2021年，战略整合，汇豪脚轮更名为大世汇豪脚轮。

ABOUT DASHI/关于大世 FACTORY 工厂

Dashi Caster has a full set caster production line, including automatic casting production line, PU pouring production line, full-automatic injection equipment, automatic lathes, stamping equipment (50T-600T), automatic welding equipment, automatic galvanization assembly line, automatic riveting equipment, automatic assembling and packing equipments ect.

青岛大世脚轮拥有脚轮生产关键工序所需的生产设备，主要包括：自动铸造流水线，PU轮浇注流水线，全自动注塑设备，自动加工车床，从50吨到600吨的冲压设备，自动焊接设备，自动电镀流水线，自动铆合设备，自动组装打包设备等。



Automatic Casting Production Line
自动铸造流水线



Automatic Lathes
自动加工车床



PU Pouring Production Line
PU轮浇注流水线



Full-automatic Injection Equipment
全自动注塑设备



Stamping Equipment
冲压设备



Automatic Welding Equipment
自动焊接设备



Automatic Galvanization Assembly Line
自动电镀流水线



Automatic Riveting Equipment
自动铆合设备



Automatic Packaging Line
自动打包线

ABOUT DASHI/关于大世
TESTING 检测

Every production process of Dashi caster has to go through the first inspection and process inspection, comprehensive product performance test to ensure product quality
大世脚轮每道生产工序都要经过首检和过程检验，全方位产品性能测试，保障产品质量。



Load Test For Light casters
轻型脚轮载重行走测验



Load Test For Heavy Duty Casters
重型脚轮载重行走测验

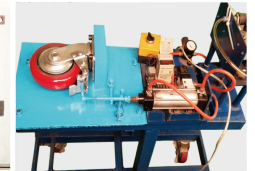

Brake Fatigue Test
刹车疲劳测验



Salt Spray Test
盐雾测验



Tensile Test
拉力测验



Impact Test
冲击测验



Rubber Vulcanization Test
橡胶硫化测验



Rolling Resistance Test
滚动阻力测验



Hardness Test
硬度检测

ABOUT DASHI/关于大世
CUSTOM 定制

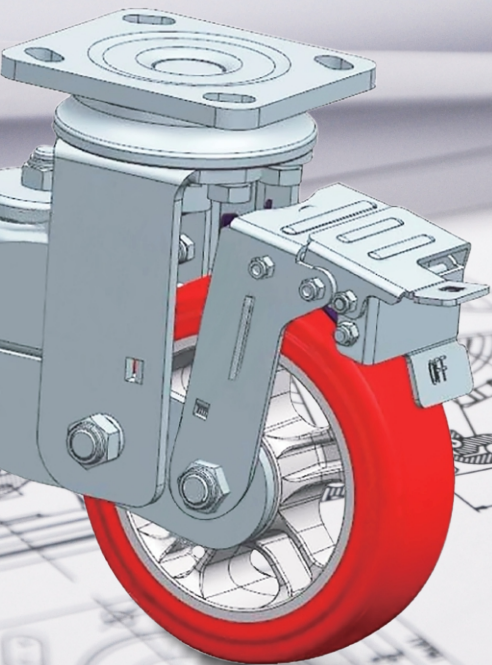

Continuous innovation, R&D from Dashi Research Team provide practical solutions for our clients constantly.

大世脚轮设计研发团队不断的创新，研究，开发，为客户提供实用的脚轮解决方案。

ABOUT DASHI/关于大世
CERTIFICATION 认证



ISO 9001:2015 Factory
GB/T 19001-2016 质量体系认证

ISO 14001:2015 Factory
GB/T 24001-2016 环境管理体系认证

OHSAS 18001:2007 Factory
GB/T 28001-2011 职业健康安全管理体系认证

RoHS Certification
RoHS 认证

Product Patents
产品专利

Third Party Inspection Accepted
接受第三方检测

HOW TO CHOOSE CASTER

Using casters can reduce the work force and increase the work efficiency. The right caster should be chosen by the manner of application, condition and request (for example facility, labour-saving, durability). The factor must be considered as follows.

THE LOAD CAPACITY

$$(1) \text{ Load: } T = \frac{E+Z}{M}$$

T=each caster load E=the weight of the vehicle
Z=the weight of moving object M=efficient load casters quantity
(the position and different heavy distribution must be considered)

(2)Efficient load caster quantity as follows



(3)The casters load a the position of maximum should be considered when choose load capacity. Concrete load position and maximum position(P2) as follows.



FLEXIBILITY

- (1)The casters should be flexible, easily used and durable. The materials with low friction coefficient or assembled parts after specified processing should be chosen as its rotating parts (such as its leg frame and wheels).
- (2)The bigger eccentric distance of the leg frame, the more flexible it rotates, with a much lower loading capacity accordingly.
- (3)The bigger wheel diameter, the less energy cost it will be, and it's better for ground protection. The bigger wheel runs slower than the smaller one, so it is not easy to have thermal deformation and is more durable. So the wheels with bigger diameter are recommended on the condition that height requirement is available during fitting.

MOVING SPEED

The requests of caster speed: at the normal temperature and on the smooth floor, the speed should be lower than 4km/h of walk and there must be a static interval during the work time.

USAGE ENVIRONMENT

Before choosing the casters, you should consider the ground material, barrier, residue and special environment (eg. Scrap iron, high or low temperature, strong acidity and basicity, grease, chemical solvent and ESD environment). Special processed casters should be chosen if they are used in special environment.

如何选择合适的脚轮

使用脚轮是为了减轻劳动强度，提高工作效率。根据应用方式、条件和要求（方便、省力、耐用）正确选择适合您使用的脚轮。请考虑以下几点：

承载重量

$$(1) \text{ 承载重量计算 } T = \frac{E+Z}{M}$$

T=每只脚轮承载的重量 E=运输工具的重量
Z=移动物体的重量 M=轮子的有效承载数量（应考虑位置、重量分布不均的因素）

(2)轮子有效承载数量（M）如下图：

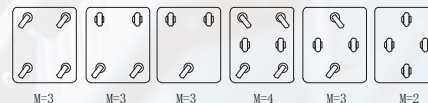

(3)选择承重时要按照最大支撑点处脚轮的承载量计算。脚轮具体受力支撑点如下图，P2为最重支撑点。

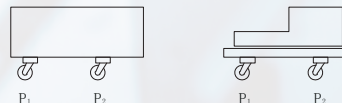

灵活性

- (1)脚轮应灵活、轻松并耐用，其转动部位（脚架转动，轮子滚动）应选用摩擦系数小的材料或经特殊工艺处理后组装的配件（如滚珠轴承或淬火处理）。
- (2)脚轮的偏心距越大转向越灵活，但承载能力相应降低。
- (3)轮子的直径越大推动越省力，并能更好地保护地面。轮子大比小转动缓慢，不易发热变形，更耐用。在安装高度允许的条件下，尽可能选择大直径的轮子。

移动速度

脚轮速度的要求：在常温环境下，在平坦的地面上，不高于步行速度4KM/H，并由一定间歇的工作状态。

使用环境

选择时应考虑地面材料、障碍物、残留物或特殊环境（如铁屑、高温、低温、酸性大、碱性大、油液和化学溶剂以及要求抗静电的场所），在特殊环境中使用的应选择用特殊材料制成的脚轮。

HOW TO CHOOSE CASTER

如何选择合适的脚轮

搬运推车种类及配置/Category of Handling Cart & Caster Deployment

搬运推车的种类 Category of Handling Cart	形状 Shape	车轮配置 Caster Deployment		搬运推车的种类 Category of Handling Cart	形状 Shape	车轮配置 Caster Deployment	
		车轮数 No. of caster	配置图 Deployment Diagram			车轮数 No. of caster	配置图 Deployment Diagram
圆形 Circle		4-5		板框车 Grid		4	
适用于在狭小的空间及短距离移动的小量载重物品。 Used for small loading equipments in the narrow space when moving in a short distance.				适用于一般装载设备及轻型物料的物品。 Used for normal loading equipments and light goods.			
扇形 Angle		3		箱子形 Box-type		6	
适用于在狭小的空间及短距离移动的小量载重物品；特殊用途。 Used for small loading equipments in the narrow space when moving in a short distance; some special usage.				适用于一般装载物及多种物料搬运。轻、重物料搬运有多种脚轮配置可选择使用。 Used for normal loading equipments and light goods, kinds of types from light to heavy class.			
平面形 Flat		3-6		铲形 Pocket shape		1	
适用于一般装载物及各种物料搬运。轻、重物料搬运有多种脚轮配置可选择使用。 Used for normal loading equipments, handling carts with different material, different kinds of types for light and heavy class.				适用于短期搬运的轻型物料搬运。 Used for light goods, labor and short distance.			
一侧支撑形 One-Side Support Form		4		杠杆形 Lever type		2	
广泛用于一般装载物搬运。轻物料搬运也可适用。 Used for normal loading equipments and light goods.				适用于短期搬运的轻型物料搬运。 Used for light goods, labor and short distance.			
两侧支撑形 Two-Side Support Form		4					
广泛用于一般装载物搬运。轻物料搬运也可适用。 Used for normal loading equipments and light goods.							

推车的规格及车轮配置

推车的规格是按照KSBB614标准，铲形和杠杆形没有规定规格。
车轮配置是公司的试验标准，长度与宽度的比例大于1以上时建议使用6只的配置。

Category of Handling Cart and Caster

Category of Handling Cart is accordance with KSBB614; no-standard for Lever type and Pocket shape.
Deployment is company testing standard, 6pcs deployment is advised when the scale of length and width is more than 2:1.

推车的长度 Length (mm)	推车的宽度 Width (mm)	车轮配置 Deployment
600	400	3, 4
630	450	4
710	450	—
750	500	—
900	600	3, 6
1200	750	6
1200†	750†	6

脚轮使用规范/Cautions for Using Casters



装载时请遵守允许负荷的规定
No overloading when using.

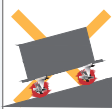

刹制装置锁住后不能停放在斜坡上。
Don't put the handling equipments on the slope when locking.



请勿在凹凸严重的地面使用。
Don't use on the uneven ground.



刹制装置锁住后不能强行推动。
Don't move the handling equipments by force when locking.

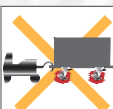

请避免利用动力对车轮进行牵引。
Push the carts by human, don't use the traction.



刹制装置，不要用铁锤敲打。
No hammering the brake part.



请避免在酸、碱盐、油、水等特殊环境中使用。
Don't use in the special irritative environment such as acid alkali and salt; Don't use if raining.



冷柜、高温、暖气室等特殊温度的场所，不要使用。
Don't use in the special temperature site such as cold, hot or warming-house.



安装丝杆型脚轮时，请务必使用扳手将丝杆的六角部拧紧。
Don't tighten too much when installing the screw-type casters.



丝杆式脚轮安装时，当刹制装置锁住后，不要用力推动脚轮。
When installing the screw-type casters, don't tighten too much after locking.

DASHI CASTER NAMING RULES

大世脚轮命名规则

DS4060 S.BK.A1 UC(48 ,6203)

DS	40	60	S	BK
Brand-DS 品牌-大世	SERIES/系列编号	WHEEL DIAMETER 轮子尺寸	CASTER TYPE 支架类型	BRAKE TYPE 刹车方式
		inch mm	R Rigid 定向 S Swivel 转向	SB Side Lock Brake 侧面刹车装置
	20 Series/系列	1" 25		BK Top Lock Brake 轮面顶刹装置
	30 Series/系列	1.5" 37.5		WB Wheel Brake 轮面正刹装置
	32 Series/系列	2" 50		SWB Swivel & Wheel Lock Brake 轮子支架全刹装置
	34 Series/系列	2.5" 63		SWL 4 Position Swivel Lock 四点旋转定位装置
	40 Series/系列	3" 75		DLB Direction Lock Brake 八角杆式
	42 Series/系列	3.5" 87.5		SCB Special Custom Brake 专用定制刹车
	45 Series/系列	4" 102		
	50 Series/系列	5" 125		
	60 Series/系列	6" 150		
	70 Series/系列	8" 200		
	80 Series/系列	10" 250		
	91 Series/系列	12" 300		

A1	UC	48	6203
MOUNTING TYPE 安装方式	WHEEL TYPE 轮子种类	WHEEL WIDTH 轮子宽度	BEARING TYPE 轮子轴承
A Top Plate 平板式	UC Polyurethane Tread Cast Iron Core Wheels 铁芯聚氨酯橡胶轮	20mm	NB Roller Bearing 滚针轴承
B Threaded Stem 螺栓式	HUC Heavy Duty Polyurethane Tread Cast Iron Core Wheels 铁芯高载重聚氨酯橡胶轮	24mm	6201 6201 Ball Bearing 6201滚珠轴承
C Square Stem 四角杆式	RC Rubber Tread Cast Iron Core Wheels 铁芯橡胶轮	26mm	6202 6202 Ball Bearing 6202滚珠轴承
D Grip Ring Stem 卡簧杆式	UA Polyurethane Tread Cast Aluminum Core Wheels 铝芯聚氨酯橡胶轮	27mm	6203 6203 Ball Bearing 6203滚珠轴承
E Round Stem 圆柱杆式	RA Gray Rubber Tread Aluminum Core Wheels 铝芯橡胶轮	28mm	6204 6204 Ball Bearing 6204滚珠轴承
F Octagon Stem 八角杆式	US Polyurethane Tread Steel Disk Core Wheels 钢盘芯聚氨酯橡胶轮	30mm	6205 6205 Ball Bearing 6205滚珠轴承
G Welded Pipe Stem 焊管式	HPU HPU Transparent Wheels 塑料芯透明聚氨酯橡胶轮	31mm	6001 6001 Ball Bearing 6001滚珠轴承
H Hole Top Stem 孔顶式	TPU Polyurethane Tread Plastic Core Wheels 塑料芯聚氨酯橡胶轮	32mm	6002 6002 Ball Bearing 6002滚珠轴承
	PVC PVC Plastic Wheels 塑料芯PVC轮	33mm	6003 6003 Ball Bearing 6003滚珠轴承
	TPE TPE Rubber Tread Plastic Core Wheels 塑料芯静音TPE轮	34mm	6004 6004 Ball Bearing 6004滚珠轴承
	LP Light Duty Plastic Wheels 轻型PP塑料轮	35mm	6005 6005 Ball Bearing 6005滚珠轴承
	HP Heavy Duty plastic Wheels 重型PP塑料轮	38mm	6006 6006 Ball Bearing 6006滚珠轴承
	HDP Super Heavy Duty Plastic Wheels 超重型PP塑料轮	40mm	6008 6008 Ball Bearing 6008滚珠轴承
	NY Nylon Wheels 尼龙轮	43mm	CB600 CB600 Ball Bearing CB600滚珠轴承
	PA Nylon and Glass Fiber Wheels 尼龙玻纤轮	44mm	DELNR Delrin Bearing 特灵轴承
	PH Phenolic Wheels 酚醛耐高温轮	47mm	RB Rivet Bearing 螺栓&铆钉
	SS Cast Iron Wheels 铸铁轮	48mm	
	FR Foaming Rubber Wheels 发泡橡胶轮	50mm	
	V V-type Cast Iron Wheels V型铸铁轮	60mm	
	U U-type Cast Iron Wheels U型铸铁轮	64mm	
		100mm	

CONTENTS/目录

01	LIGHT DUTY CASTERS 轻型脚轮 50-200KG	DS-20	
05	HEAVY DUTY CASTERS 重型脚轮 300-6000KG	DS-40 TQ-40 DS-42 DS-45 DS-50 DS-70	
33	SHOCK ABSORBING CASTERS 缓冲减震脚轮 200-1500KG	DS-91 DS-91 ^(2.00) DS-93 DS-94 DS-98	

43	FUNCTIONAL CASTERS 功能型脚轮 80-1000KG	DS-20 DS-40 DS-60 DS-80	
59	APPENDIX 附录	Mounting Type 可选择安装方式	

LIGHT DUTY CASTERS / 轻型脚轮

DS-20 (80-180KG)



DS20 R.A1 TPU
Rigid定向

DS20 S.A1 TPU
Swivel转向

DS20 S.SWB.A1 TPU
Dual Lock Brake双刹

DS20 S.BK.A1 TPU
Side Lock Brake侧刹

Usage 用途

Industrial custodian car; small handling equipment; all kinds of light duty handling equipment.
各种工业用保管台车, 小型搬运设备, 各种轻型物品搬运器具等。

STEERING STRUCTURE DIAGRAM / 滚盘图

Double steel-ball track, more stable and strong;
双层钢珠轨道, 更加稳定牢固;

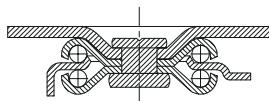
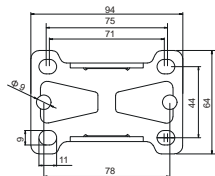
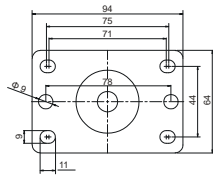

PLATE / 底板

Please refer to the attachment for more mounting data details of plate brackets.
更多平板支架安装方式的数据尺寸, 详见附录



Rigid 定向底板



Swivel 转向底板

LIGHT DUTY CASTERS / 轻型脚轮

DS-20 (80-180KG)



OPTIONS / 可选项

WHEEL / 轮子



TPU
Polyurethane Tread Plastic Core
塑料芯聚氨酯



TPE
TPE Tread Plastic Core
塑料芯弹性TPE



PVC
PVC Tread Plastic Core
塑料芯PVC

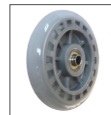

HPU
HPU Transparent
塑料芯透明聚氨酯



LP
Light Duty Plastic
轻型塑料



HP
Heavy Duty Plastic
重型塑料



HDP
Super Heavy Duty Plastic
超重型塑料



NY
Nylon
尼龙

BEARING / 轴承



Rivet Bearing
螺栓



Deep Groove Ball Bearing
深沟球轴承



Customized Bearing
专用定制轴承

FASTENING TYPE / 安装方式



Plate Type
平板式



Threaded Stem
螺栓式



Square Stem
四方杆式



Grip Ring Stem
卡圈杆式



Round Stem
圆柱杆式



Octagon Stem
八角杆式



Welded Pipe Stem
焊管式



Hole Top Stem
孔顶式

LIGHT DUTY CASTERS / 轻型脚轮

DS-20 (80-180KG)

PRODUCT DATA / 产品数据

规格 Size in(mm)	材质 Wheel Type		轴承种类 Bearing	承重 Load Capacity kg	轮宽 Tread Width mm	总高度 Overall Height mm	旋转半径 Swivel Radius		
	转向 Swivel	制动 Brake	双刹 Dual Lock Brake	mm	mm	mm	mm	mm	mm
3(76)	TPU	塑料芯聚氨酯 Polyurethane Tread Plastic Core	BB 6000 深沟球轴承 BB 6000 Deep Groove Ball Bearing	120	30	101	72	76	117
			6202 深沟球轴承 6202 Deep Groove Ball Bearing	110	31	101			
	TPE	塑料芯静音TPE TPE Tread Plastic Core	BB 6000 深沟球轴承 BB 6000 Deep Groove Ball Bearing	100	30	101			
			6202 深沟球轴承 6202 Deep Groove Ball Bearing	100	31	101			
	PVC	塑料芯PVC PVC Tread Plastic Core	BB 6000 深沟球轴承 BB 6000 Deep Groove Ball Bearing	80	30	101			
	HPU	塑料芯高弹透明聚氨酯 HPU Transparent	BB 6000 深沟球轴承 BB 6000 Deep Groove Ball Bearing	90	30	101			
	LP	轻型塑料 Light Duty Plastic	螺栓 Rivet Bearing	100	32	101			
	HP	重型塑料 Heavy Duty Plastic	螺栓 Rivet Bearing	120	35	101			
	HDP	超重型塑料 Super Heavy Duty Plastic	螺栓 Rivet Bearing	135	31	101			
NY	尼龙 Nylon	螺栓 Rivet Bearing	120	32	101				
4(100)	TPU	塑料芯聚氨酯 Polyurethane Tread Plastic Core	BB6000 深沟球轴承 BB 6000 Deep Groove Ball Bearing	130	30	127	85.5	90	117
			6202 深沟球轴承 6202 Deep Groove Ball Bearing	120	31	127			
	TPE	塑料芯静音TPE TPE Tread Plastic Core	BB 6000 深沟球轴承 BB 6000 Deep Groove Ball Bearing	110	30	127			
			6202 深沟球轴承 6202 Deep Groove Ball Bearing	110	31	127			
	PVC	塑料芯PVC PVC Tread Plastic Core	BB6000 深沟球轴承 BB6000 Deep Groove Ball Bearing	90	30	127			
	HPU	塑料芯高弹透明聚氨酯 HPU Transparent	BB 6000 深沟球轴承 BB 6000 Deep Groove Ball Bearing	105	30	127			
	LP	轻型塑料 Light Duty Plastic	螺栓 Rivet Bearing	125	32	127			

LIGHT DUTY CASTERS / 轻型脚轮

DS-20 (80-180KG)

PRODUCT DATA / 产品数据

规格 Size in(mm)	材质 Wheel Type		轴承种类 Bearing	承重 Load Capacity kg	轮宽 Tread Width mm	总高度 Overall Height mm	旋转半径 Swivel Radius		
	转向 Swivel	制动 Brake	双刹 Dual Lock Brake	mm	mm	mm	mm	mm	mm
4(100)	HP	重型塑料 Heavy Duty Plastic	螺栓 Rivet Bearing	150	38	127	85.5	90	117
	HDP	超重型塑料 Super Heavy Duty Plastic	螺栓 Rivet Bearing	170	31	127			
	NY	尼龙 Nylon	螺栓 Rivet Bearing	145	32	127			
5(127)	TPU	塑料芯聚氨酯 Polyurethane Tread Plastic Core	BB 6000 深沟球轴承 BB 6000 Deep Groove Ball Bearing	140	30	157	101.5	101.5	117
			6202 深沟球轴承 6202 Deep Groove Ball Bearing	130	31	157			
	TPE	塑料芯静音TPE TPE Tread Plastic Core	BB 6000 深沟球轴承 BB 6000 Deep Groove Ball Bearing	120	30	157			
			6202 深沟球轴承 6202 Deep Groove Ball Bearing	120	31	157			
	PVC	塑料芯PVC PVC Tread Plastic Core	BB 6000 深沟球轴承 BB 6000 Deep Groove Ball Bearing	100	30	157			
	HPU	塑料芯高弹透明聚氨酯 HPU Transparent	BB 6000 深沟球轴承 BB 6000 Deep Groove Ball Bearing	115	30	157			
	LP	轻型塑料 Light Duty Plastic	螺栓 Rivet Bearing	135	32	157			
	HP	重型塑料 Heavy Duty Plastic	螺栓 Rivet Bearing	170	38	157			
	HDP	超重型塑料 Super Heavy Duty Plastic	螺栓 Rivet Bearing	180	31	157			
	NY	尼龙 Nylon	螺栓 Rivet Bearing	165	32	157			

HEAVY DUTY CASTERS/重型脚轮 DS-30 (80-450KG)



DS30 R-A1 NY
Rigid定向



DS30 S-A1 NY
Swivel转向



DS30 S.BK-A1 NY
Side Lock Brake侧刹

**Usage
用途**

Supermarket computer, electronic computer, medical equipment.
超市电脑用, 电子计算机用, 医疗设备用。

STEERING STRUCTURE DIAGRAM/滚盘图

Double steel-ball track, more flexible;
双层钢球轨道, 旋转更灵活。

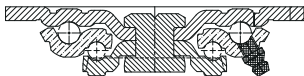

PLATE/底板

Please refer to the attachment for more mounting size details of plate bracket.
请参考附件安装板力矩的数据尺寸, 详见附表

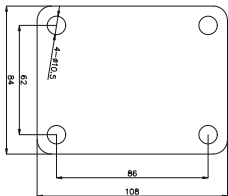

Rigid 定向底板

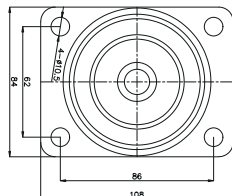

Swivel 转向底板

HEAVY DUTY CASTERS/重型脚轮 DS-30 (80-450KG)



OPTIONS/可选项

WHEEL/轮子



NY
Nylon
尼龙



HDP
Super Heavy Duty Plastic
超重型塑料

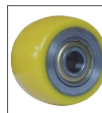

HUC
Heavy Duty Polyurethane
Tread Cast Iron Core
高载重铁芯聚氨酯

PRODUCT DATA/产品数据

规格 Size in(mm)	材质 Wheel Type		轴承种类 Bearing	承重 Load Capacity kg	轮宽 Tread Width mm	总高度 Overall Height mm	转向 Swivel mm	侧刹 Brake mm
	3(76)	NY 尼龙 Nylon	6002 深沟球轴承 6002 Deep Groove Ball Bearing	450	47	103	61	61
HDP 超重型塑料 Super Heavy Duty Plastic		450	47					
HUC 高载重铁芯聚氨酯 Heavy Duty Polyurethane Tread Cast Iron Core		450	47					

HEAVY DUTY CASTERS / 重型脚轮

DS-32 (120-370KG)



DS32 RA1 US
Rigid定向



DS32 S.A1 US
Swivel转向



DS32 S.BK1 US
Side Lock Brake侧刹

Usage 用途

Turnover equipments under cold environment, roll-box, handling equipment of electronics, noise proof handling equipment, logistics warehouse.
低温环境周转设备, 配送中轧辊箱, 电子产品用搬运设备, 防噪音的搬运设备, 物流仓库用。

STEERING STRUCTURE DIAGRAM/滚盘图

Double steel-ball track, more stable and strong;
双层钢球轨道, 更加稳定和坚固;

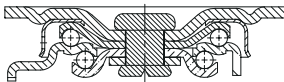

PLATE/底板

Please refer to the attachment for more mounting data details of plate bracket.
更多平板支架安装力矩的规格尺寸, 详见附表

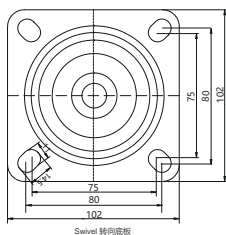
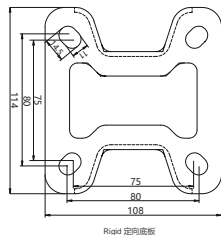

HEAVY DUTY CASTERS / 重型脚轮

DS-32 (120-370KG)



OPTIONS/可选项

WHEEL/轮子

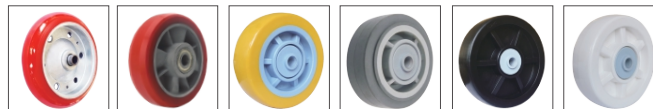

US 聚氨酯耐磨 Tread Steel Disk Core
Polyurethane Tread Steel Disk Core
UA 聚氨酯耐磨 Tread Cast Aluminum Core
Polyurethane Tread Cast Aluminum Core
TPU 塑料芯聚氨酯 Tread Plastic Core
Polyurethane Tread Plastic Core
TPE 塑料芯聚氨酯 TPE Tread Plastic Core
TPE Tread Plastic Core
PP PP塑料 PP Plastic
NY 尼龙 Nylon

BEARING/轴承



Deep Groove Ball Bearing 深沟球轴承
Roller Bearing 滚针轴承
Integrated Ball Bearing 一体滚珠轴承

PRODUCT DATA/产品数据

规格 Size (in/mm)	材质 Wheel Type	轴承种类 Bearing	KG	轮宽	总高度 Overall Height mm	转向 Swivel mm	侧刹 Brake mm	
			承重 Load Capacity kg	Tread Width mm				
4(101)	US	聚氨酯耐磨 Tread Steel Disk Core	一体滚珠轴承 Integrated Ball Bearing	150	40	143	101	101
	UA	聚氨酯耐磨 Tread Cast Aluminum Core	6202 深沟球轴承 6202 Deep Groove Ball Bearing	250	40			
	TPU	塑料芯聚氨酯 Tread Plastic Core	滚针轴承 Roller Bearing	180	40			
			6202 深沟球轴承 6202 Deep Groove Ball Bearing	180	40			
			6203 深沟球轴承 6203 Deep Groove Ball Bearing	180	40			
	TPE	塑料芯聚氨酯 TPE Tread Plastic Core	滚针轴承 Roller Bearing	150	40			
			6202 深沟球轴承 6202 Deep Groove Ball Bearing	150	40			
			6203 深沟球轴承 6203 Deep Groove Ball Bearing	150	40			
	PP	PP 塑料 PP Plastic	滚针轴承 Roller Bearing	150	40			
			6202 深沟球轴承 6202 Deep Groove Ball Bearing	150	40			
			6203 深沟球轴承 6203 Deep Groove Ball Bearing	150	40			
	NY	尼龙 Nylon	滚针轴承 Roller Bearing	200	40			
6202 深沟球轴承 6202 Deep Groove Ball Bearing			200	40				
6203 深沟球轴承 6203 Deep Groove Ball Bearing			200	40				

HEAVY DUTY CASTERS / 重型脚轮

DS-32 (120-370KG)

PRODUCT DATA / 产品数据

规格 Size in(mm)	材质 Wheel Type	轴承种类 Bearing	承重 Load Capacity	轮宽 Tread Width	总高度 Overall Height	旋转半径 Swivel Radius		
			kg	mm	mm	转向 Swivel	侧刹 Brake	
5(127)	US	钢板芯聚氨酯 Tread Steel Disk Core	一体滚珠轴承 Integrated Ball Bearing	220	40	165	104	104
			6202 深沟球轴承 6202 Deep Groove Ball Bearing	280	40			
	UA	铝芯聚氨酯 Polyurethane Tread Cast Aluminum Core	滚针轴承 Roller Bearing	220	40			
			6202 深沟球轴承 6202 Deep Groove Ball Bearing	220	40			
	TPU	塑料芯聚氨酯 Tread Plastic Core	滚针轴承 Roller Bearing	200	40			
			6203 深沟球轴承 6203 Deep Groove Ball Bearing	220	40			
	TPE	塑料芯静音TPE TPE Tread Plastic Core	滚针轴承 Roller Bearing	200	40			
			6203 深沟球轴承 6203 Deep Groove Ball Bearing	200	40			
	PP	PP 塑料 PP Plastic	滚针轴承 Roller Bearing	200	40			
			6202 深沟球轴承 6202 Deep Groove Ball Bearing	200	40			
			6203 深沟球轴承 6203 Deep Groove Ball Bearing	200	40			
			滚针轴承 Roller Bearing	250	40			
6202 深沟球轴承 6202 Deep Groove Ball Bearing			250	40				
6203 深沟球轴承 6203 Deep Groove Ball Bearing			250	40				
NY	尼龙 Nylon	滚针轴承 Roller Bearing	250	40				
		6202 深沟球轴承 6202 Deep Groove Ball Bearing	250	40				
		6203 深沟球轴承 6203 Deep Groove Ball Bearing	250	40				
6(150)	US	钢板芯聚氨酯 Polyurethane Tread Steel Disk Core	一体滚珠轴承 Integrated Ball Bearing	250	40	190	116	116
			6202 深沟球轴承 6202 Deep Groove Ball Bearing	300	40			
	UA	铝芯聚氨酯 Polyurethane Tread Cast Aluminum Core	滚针轴承 Roller Bearing	250	40			
			6202 深沟球轴承 6202 Deep Groove Ball Bearing	250	40			
	TPU	塑料芯聚氨酯 Polyurethane Tread Plastic Core	滚针轴承 Roller Bearing	250	40			
			6203 深沟球轴承 6203 Deep Groove Ball Bearing	250	40			
TPE	塑料芯静音TPE TPE Tread Plastic Core	滚针轴承 Roller Bearing	250	40				
		6203 深沟球轴承 6203 Deep Groove Ball Bearing	250	40				

HEAVY DUTY CASTERS / 重型脚轮

DS-32 (120-370KG)



PRODUCT DATA / 产品数据

规格 Size in(mm)	材质 Wheel Type	轴承种类 Bearing	承重 Load Capacity	轮宽 Tread Width	总高度 Overall Height	旋转半径 Swivel Radius		
			kg	mm	mm	转向 Swivel	侧刹 Brake	
6(150)	PP	PP 塑料 PP Plastic	滚针轴承 Roller Bearing	250	40	190	116	116
			6202 深沟球轴承 6202 Deep Groove Ball Bearing	250	40			
			6203 深沟球轴承 6203 Deep Groove Ball Bearing	250	40			
	NY	尼龙 Nylon	滚针轴承 Roller Bearing	300	40			
			6202 深沟球轴承 6202 Deep Groove Ball Bearing	300	40			
			6203 深沟球轴承 6203 Deep Groove Ball Bearing	300	40			
8(203)	US	钢板芯聚氨酯 Polyurethane Tread Steel Disk Core	一体滚珠轴承 Integrated Ball Bearing	300	40	241	142	142
			6202 深沟球轴承 6202 Deep Groove Ball Bearing	350	40			
	UA	铝芯聚氨酯 Polyurethane Tread Cast Aluminum Core	滚针轴承 Roller Bearing	300	40			
			6202 深沟球轴承 6202 Deep Groove Ball Bearing	300	40			
	TPU	塑料芯聚氨酯 Polyurethane Tread Plastic Core	滚针轴承 Roller Bearing	300	40			
			6203 深沟球轴承 6203 Deep Groove Ball Bearing	300	40			
	TPE	塑料芯静音TPE TPE Tread Plastic Core	滚针轴承 Roller Bearing	300	40			
			6202 深沟球轴承 6202 Deep Groove Ball Bearing	300	40			
	PP	PP 塑料 PP Plastic	滚针轴承 Roller Bearing	300	40			
			6202 深沟球轴承 6202 Deep Groove Ball Bearing	300	40			
			6203 深沟球轴承 6203 Deep Groove Ball Bearing	300	40			
			滚针轴承 Roller Bearing	350	40			
6202 深沟球轴承 6202 Deep Groove Ball Bearing			350	40				
6203 深沟球轴承 6203 Deep Groove Ball Bearing			350	40				
NY	尼龙 Nylon	滚针轴承 Roller Bearing	350	40				
		6202 深沟球轴承 6202 Deep Groove Ball Bearing	350	40				
		6203 深沟球轴承 6203 Deep Groove Ball Bearing	350	40				

HEAVY DUTY CASTERS / 重型脚轮 DS-34 (120-300KG)



DS34 RA1 UC
Rigid定向



DS34 S.A1 UC
Swivel转向



DS34 S.BK.A1 UC
Side Lock Brake侧刹

Usage 用途 Warehouse logistics, automobile industry, machinery manufacturing and other industries handling equipment, tooling tools and logistics trolley. 仓储物流、汽车工业、机械制造等行业搬运器具、工装工具和物流台车用。

STEERING STRUCTURE DIAGRAM/滚盘图

Double steel-ball track, more stable and strong;
双层钢球轨道，更加稳定和坚固；

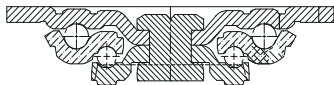

PLATE/底板

Please refer to the attachment for more accurate details of plate bracket.
请参考附件获取更准确的板架细节。附送图例。

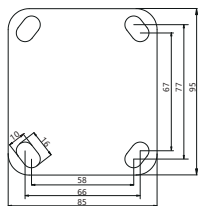

Rigid 定向底板

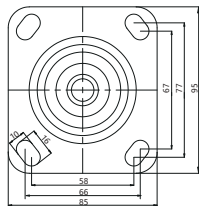

Swivel 转向底板

HEAVY DUTY CASTERS / 重型脚轮 DS-34 (120-300KG)



OPTIONS/可选项

WHEEL/轮子

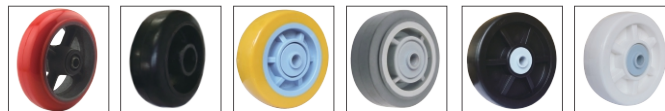

UC 聚氨酯 PU Polyurethane Tread Cast Iron Core
RC 橡胶胶粒 Rubber Tread Cast Iron Core
TPU 热塑性聚氨酯 Polyurethane Tread Plastic Core
TPE 热塑性弹性体 TPE Tread Plastic Core
PP 聚丙烯 PP Plastic
NY 尼龙 Nylon

BEARING/轴承



Deep Groove Ball Bearing
深沟球轴承

Roller Bearing
滚针轴承

BRACKET/支架



Galvanized Bracket
镀锌支架

SS304 Bracket
304不锈钢支架

HEAVY DUTY CASTERS / 重型脚轮

DS-34 (120-300KG)

PRODUCT DATA / 产品数据

规格 Size in(mm)	材质 Wheel Type		轴承种类 Bearing	承重 Load Capacity	轮宽 Tread Width	总高度 Overall Height	旋转半径 Swivel Radius	
				kg	mm	mm	转向 Swivel	侧刹 Brake
3(75)	UC	铁芯聚氨酯 Polyurethane Tread Cast Iron Core	6201 深沟球轴承 6201 Deep Groove Ball Bearing	150	35	105	56.5	63
			6202 深沟球轴承 6202 Deep Groove Ball Bearing	150	38			
			6203 深沟球轴承 6203 Deep Groove Ball Bearing	150	40			
	TPU	塑料芯聚氨酯 Polyurethane Tread Plastic Core	滚针轴承 Roller Bearing	150	40			
			6202 深沟球轴承 6202 Deep Groove Ball Bearing	150	40			
			6203 深沟球轴承 6203 Deep Groove Ball Bearing	120	40			
	TPE	塑料芯静音TPE TPE Tread Plastic Core	滚针轴承 Roller Bearing	150	40			
			6202 深沟球轴承 6202 Deep Groove Ball Bearing	150	40			
			6203 深沟球轴承 6203 Deep Groove Ball Bearing	150	40			
	PP	PP塑料 PP Plastic	滚针轴承 Roller Bearing	120	40			
			6202 深沟球轴承 6202 Deep Groove Ball Bearing	120	40			
			6203 深沟球轴承 6203 Deep Groove Ball Bearing	120	40			
NY	尼龙 Nylon	滚针轴承 Roller Bearing	150	40				
		6202 深沟球轴承 6202 Deep Groove Ball Bearing	150	40				
		6203 深沟球轴承 6203 Deep Groove Ball Bearing	150	40				

HEAVY DUTY CASTERS / 重型脚轮

DS-34 (120-300KG)



Waterproof 防水 Labor-saving 省力 Wearproof 耐磨

PRODUCT DATA / 产品数据

规格 Size in(mm)	材质 Wheel Type		轴承种类 Bearing	承重 Load Capacity	轮宽 Tread Width	总高度 Overall Height	旋转半径 Swivel Radius	
				kg	mm	mm	转向 Swivel	侧刹 Brake
4(100)	UC	铁芯聚氨酯 Polyurethane Tread Cast Iron Core	6201 深沟球轴承 6201 Deep Groove Ball Bearing	220	33	135	75.5	87.5
			6202 深沟球轴承 6202 Deep Groove Ball Bearing	270	38			
			6202 深沟球轴承 6202 Deep Groove Ball Bearing	220	33			
			6203 深沟球轴承 6203 Deep Groove Ball Bearing	220	38			
	RC	铁芯橡胶 Rubber Tread Cast Iron Core	滚针轴承 Roller Bearing	115	33			
			滚针轴承 Roller Bearing	115	38			
	TPU	塑料芯聚氨酯 Polyurethane Tread Plastic Core	滚针轴承 Roller Bearing	220	40			
			6202 深沟球轴承 6202 Deep Groove Ball Bearing	220	40			
			6203 深沟球轴承 6203 Deep Groove Ball Bearing	180	40			
	TPE	塑料芯静音TPE TPE Tread Plastic Core	滚针轴承 Roller Bearing	220	40			
			6202 深沟球轴承 6202 Deep Groove Ball Bearing	220	40			
			6203 深沟球轴承 6203 Deep Groove Ball Bearing	220	40			
PP	PP塑料 PP Plastic	滚针轴承 Roller Bearing	190	40				
		6202 深沟球轴承 6202 Deep Groove Ball Bearing	190	40				
		6203 深沟球轴承 6203 Deep Groove Ball Bearing	190	40				
NY	尼龙 Nylon	滚针轴承 Roller Bearing	220	40				
		6202 深沟球轴承 6202 Deep Groove Ball Bearing	220	40				
		6203 深沟球轴承 6203 Deep Groove Ball Bearing	220	40				

HEAVY DUTY CASTERS / 重型脚轮

DS-34 (120-300KG)

PRODUCT DATA / 产品数据

规格 Size in(mm)	材质 Wheel Type		轴承种类 Bearing	承重 Load Capacity kg	轮宽 Tread Width mm	总高度 Overall Height mm	旋转半径 Swivel Radius	
							转向 Swivel mm	侧刹 Brake mm
5(127)		UC 铁芯聚氨酯 Polyurethane Tread Cast Iron Core	6201 深沟球轴承 6201 Deep Groove Ball Bearing	250	40	160.5	93	93
			6202 深沟球轴承 6202 Deep Groove Ball Bearing	250	40			
		RC 铁芯橡胶 Rubber Tread Cast Iron Core	滚针轴承 Roller Bearing	135	40			
			滚针轴承 Roller Bearing	250	40			
		TPU 塑料芯聚氨酯 Polyurethane Tread Plastic Core	6202 深沟球轴承 6202 Deep Groove Ball Bearing	250	40			
			6203 深沟球轴承 6203 Deep Groove Ball Bearing	210	40			
			滚针轴承 Roller Bearing	250	40			
		TPE 塑料芯静音TPE TPE Tread Plastic Core	6202 深沟球轴承 6202 Deep Groove Ball Bearing	250	40			
			6203 深沟球轴承 6203 Deep Groove Ball Bearing	250	40			
			滚针轴承 Roller Bearing	220	40			
		PP PP塑料 PP Plastic	6202 深沟球轴承 6202 Deep Groove Ball Bearing	220	40			
			6203 深沟球轴承 6203 Deep Groove Ball Bearing	220	40			
滚针轴承 Roller Bearing			250	40				
	NY 尼龙 Nylon	6202 深沟球轴承 6202 Deep Groove Ball Bearing	250	40				
		6203 深沟球轴承 6203 Deep Groove Ball Bearing	250	40				
		滚针轴承 Roller Bearing	250	40				

HEAVY DUTY CASTERS / 重型脚轮

DS-34 (120-300KG)



PRODUCT DATA / 产品数据

规格 Size in(mm)	材质 Wheel Type		轴承种类 Bearing	承重 Load Capacity kg	轮宽 Tread Width mm	总高度 Overall Height mm	旋转半径 Swivel Radius	
							转向 Swivel mm	侧刹 Brake mm
6(152)		UC 铁芯聚氨酯 Polyurethane Tread Cast Iron Core	6201 深沟球轴承 6201 Deep Groove Ball Bearing	300	40	191	109.5	109.5
			6202 深沟球轴承 6202 Deep Groove Ball Bearing	300	40			
		RC 铁芯橡胶 Rubber Tread Cast Iron Core	滚针轴承 Roller Bearing	150	40			
			滚针轴承 Roller Bearing	280	40			
		TPU 塑料芯聚氨酯 Polyurethane Tread Plastic Core	6202 深沟球轴承 6202 Deep Groove Ball Bearing	280	40			
			6203 深沟球轴承 6203 Deep Groove Ball Bearing	250	40			
			滚针轴承 Roller Bearing	280	40			
		TPE 塑料芯静音TPE TPE Tread Plastic Core	6202 深沟球轴承 6202 Deep Groove Ball Bearing	280	40			
			6203 深沟球轴承 6203 Deep Groove Ball Bearing	250	40			
			滚针轴承 Roller Bearing	250	40			
		PP PP塑料 PP Plastic	6202 深沟球轴承 6202 Deep Groove Ball Bearing	250	40			
			6203 深沟球轴承 6203 Deep Groove Ball Bearing	250	40			
滚针轴承 Roller Bearing			280	40				
	NY 尼龙 Nylon	6202 深沟球轴承 6202 Deep Groove Ball Bearing	280	40				
		6203 深沟球轴承 6203 Deep Groove Ball Bearing	280	40				
		滚针轴承 Roller Bearing	280	40				

HEAVY DUTY CASTERS/重型脚轮 DS-40 (120-600KG)



DS40 R.A1 UC
Rigid定向

DS40 S.A1 UC
Swivel转向

DS40 S.SWB.A1 UC
Dual Lock 双锁

DS40 S.SK.A1 UC
Side Lock Brake 侧锁

Usage 用途 Warehouse logistics, automobile industry, machinery manufacturing and other industries handling equipment, tooling tools and logistics trolley, 仓储物流、汽车工业、机械制造等行业搬运器具、工装工具和物流台车用。

STEERING STRUCTURE DIAGRAM/ 滚盘图

Double steel-ball track, more stable and strong;
双层钢球轨道, 更加稳定和坚固;

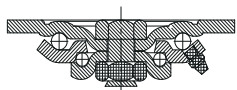

SWIVEL LOCK/方向锁

Swivel lock: change the orientation of universal
方向锁: 让方向变定向;



Locking
锁止状态



Opening
松开状态



PSL
方向锁

PLATE/底板

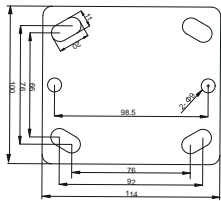

Rigid 定向底板

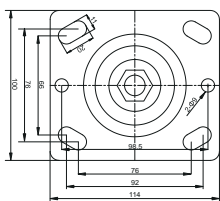

Swivel 转向底板

HEAVY DUTY CASTERS/重型脚轮 DS-40 (120-600KG)



Waterproof 防水 Labor-saving 省力 Wearproof 耐磨

OPTIONS/可选项

WHEEL/轮子



UC
聚氨酯耐磨
Polyurethane Tread Cast Iron Core



HUC
聚氨酯耐磨
Heavy Duty Polyurethane Tread Cast Iron Core



UA
聚氨酯耐磨
Polyurethane Tread Cast Aluminum Core



TPU
聚氨酯耐磨
Polyurethane Tread Plastic Core



FR
发泡橡胶
Foaming Rubber Tread Plastic Core

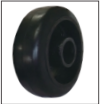

RC
橡胶胎
Rubber Tread Cast Iron Core



PP
PP塑料
PP Plastic



NY
尼龙
Nylon



PVC
塑料芯PVC
PVC Tread Plastic Core



TPE
塑料芯热塑性TPE
TPE Tread Plastic Core



SS
铸钢
Steel

BEARING/轴承



Deep Groove Ball Bearing
深沟球轴承



Roller Bearing
滚针轴承



Roller Bearing
特尔灵轴承

BRACKET/支架



Galvanized Stents
镀锌支架



SS304 Bracket
304不锈钢支架



Welded Pipe Stem
焊管式

More detail details of bracket mounting are enclosed here for your reference.
更多详细支架安装方式的教程, 详见附录

HEAVY DUTY CASTERS/重型脚轮 DS-40 (120-500KG)

PRODUCT DATA/产品数据

规格 Size in(mm)	材质 Wheel Type	轴承种类 Bearing	承重 Load Capacity	轮宽 Tread Width	总高度 Overall Height	旋转半径 Swivel Radius		
			kg	mm	mm	转向 Swivel	侧刹 Brake	双刹 Dual Lock Brake
4(101)	UC 聚氨酯履带 Polyurethane Tread Cast Iron Core	6201 深沟球轴承 6201 Deep Groove Ball Bearing	320	48	143	80.5	93.5	141
		6203 深沟球轴承 6203 Deep Groove Ball Bearing	320	48				
	HJLC 铁芯高载重聚氨酯履带 Heavy Duty Polyurethane Tread Cast Iron Core	6203 深沟球轴承 6203 Deep Groove Ball Bearing	450	48				
		6203 深沟球轴承 6203 Deep Groove Ball Bearing	320	50				
	UA 铝芯聚氨酯履带 Polyurethane Tread Cast Aluminum Core	6203 深沟球轴承 6203 Deep Groove Ball Bearing	320	50				
		滚针轴承 Roller Bearing	250	50				
	TPU 塑料芯聚氨酯履带 Polyurethane Tread Plastic Core	6202 深沟球轴承 6202 Deep Groove Ball Bearing	250	50				
		滚针轴承 Roller Bearing	160	50				
	PVC 塑料芯PVC履带 PVC Tread Plastic Core	滚针轴承 Roller Bearing	160	50				
	TPE 塑料芯TPE履带 TPE Tread Plastic Core	6202 深沟球轴承 6202 Deep Groove Ball Bearing	160	50				
FR 发泡橡胶履带 Foaming Rubber Tread Plastic Core	6202 深沟球轴承 6202 Deep Groove Ball Bearing	120	50					
PP PP塑料履带 PP Plastic	6203 深沟球轴承 6203 Deep Groove Ball Bearing	100	50					
NY 尼龙履带 Nylon	6203 深沟球轴承 6203 Deep Groove Ball Bearing	150	50					
RC 铁芯橡胶履带 Rubber Tread Cast Iron Core	滚针轴承 Roller Bearing	160	50					
SS 钢铁轮 Steel	滚针轴承 Roller Bearing	280	50					

HEAVY DUTY CASTERS/重型脚轮 DS-40 (120-500KG)

PRODUCT DATA/产品数据

规格 Size in(mm)	材质 Wheel Type	轴承种类 Bearing	承重 Load Capacity	轮宽 Tread Width	总高度 Overall Height	旋转半径 Swivel Radius		
			kg	mm	mm	转向 Swivel	侧刹 Brake	双刹 Dual Lock Brake
5(126)	UC 聚氨酯履带 Polyurethane Tread Cast Iron Core	6201 深沟球轴承 6201 Deep Groove Ball Bearing	320	40	166	97	97	143
		6203 深沟球轴承 6203 Deep Groove Ball Bearing	340	48				
	HJLC 铁芯高载重聚氨酯履带 Heavy Duty Polyurethane Tread Cast Iron Core	6203 深沟球轴承 6203 Deep Groove Ball Bearing	500	48				
		6203 深沟球轴承 6203 Deep Groove Ball Bearing	360	50				
	UA 铝芯聚氨酯履带 Polyurethane Tread Cast Aluminum Core	6203 深沟球轴承 6203 Deep Groove Ball Bearing	360	50				
		滚针轴承 Roller Bearing	300	50				
	TPU 塑料芯聚氨酯履带 Polyurethane Tread Plastic Core	6202 深沟球轴承 6202 Deep Groove Ball Bearing	300	50				
		滚针轴承 Roller Bearing	180	50				
	PVC 塑料芯PVC履带 PVC Tread Plastic Core	滚针轴承 Roller Bearing	180	50				
	TPE 塑料芯TPE履带 TPE Tread Plastic Core	6202 深沟球轴承 6202 Deep Groove Ball Bearing	200	50				
FR 发泡橡胶履带 Foaming Rubber Tread Plastic Core	6202 深沟球轴承 6202 Deep Groove Ball Bearing	160	50					
PP PP塑料履带 PP Plastic	6203 深沟球轴承 6203 Deep Groove Ball Bearing	100	50					
NY 尼龙履带 Nylon	6203 深沟球轴承 6203 Deep Groove Ball Bearing	150	50					
RC 铁芯橡胶履带 Rubber Tread Cast Iron Core	滚针轴承 Roller Bearing	170	47					
SS 钢铁轮 Steel	滚针轴承 Roller Bearing	350	50					

HEAVY DUTY CASTERS/重型脚轮

DS-40 (120-500KG)

PRODUCT DATA/产品数据

规格 Size in(mm)	材质 Wheel Type	轴承种类 Bearing	承重 Load Capacity	轮宽 Tread Width	总高度 Overall Height	脚轮半径 Swivel Radius			
			kg	mm	mm	转向 Swivel	侧刹 Brake	双刹 Dual Lock Brake	
61(52)	UC 铁芯聚氨酯 Polyurethane Tread Cast Iron Core	6201 深沟球轴承 6201 Deep Groove Ball Bearing	355	44	188	114	114	144	
			375	48					
		6203 深沟球轴承 6203 Deep Groove Ball Bearing	355	44					
			375	48					
	HUC 铁芯高载重聚氨酯 Heavy Duty Polyurethan Tread Cast Iron Core	6203 深沟球轴承 6203 Deep Groove Ball Bearing	550	48					
			580	50					
	TPU 塑料芯聚氨酯 Polyurethane Tread Plastic Core	滚针轴承 Roller Bearing	350	50					
			6202 深沟球轴承 6202 Deep Groove Ball Bearing	350					50
			400	43					
	PVC 塑料芯PVC PVC Tread Plastic Core	滚针轴承 Roller Bearing	200	50					
			6202 深沟球轴承 6202 Deep Groove Ball Bearing	200					43
	TPE 塑料芯TPE TPE Tread Plastic Core	6202 深沟球轴承 6202 Deep Groove Ball Bearing	260	50					
	FR 发泡橡胶 Foaming Rubber Tread Plastic Core	6202 深沟球轴承 6202 Deep Groove Ball Bearing	200	50					
	PP PP塑料 PP Plastic	6203 深沟球轴承 6203 Deep Groove Ball Bearing	150	50					
	NV 尼龙 Nylon	6203 深沟球轴承 6203 Deep Groove Ball Bearing	200	50					
	RC 橡胶 Rubber Tread Cast Iron Core	滚针轴承 Roller Bearing	190	47					
UA 铁芯聚氨酯 Polyurethane Tread Cast Aluminum Core	6203 深沟球轴承 6203 Deep Groove Ball Bearing	360	50						
SS 铸钢轮 Steel	滚针轴承 Roller Bearing	400	50						

HEAVY DUTY CASTERS/重型脚轮

DS-40 (120-500KG)

PRODUCT DATA/产品数据

规格 Size in(mm)	材质 Wheel Type	轴承种类 Bearing	承重 Load Capacity	轮宽 Tread Width	总高度 Overall Height	脚轮半径 Swivel Radius		
			kg	mm	mm	转向 Swivel	侧刹 Brake	双刹 Dual Lock Brake
8(203)	UC 铁芯聚氨酯 Polyurethane Tread Cast Iron Core	6201 深沟球轴承 6201 Deep Groove Ball Bearing	400	48	241	152.5	152.5	152.5
			6203 深沟球轴承 6203 Deep Groove Ball Bearing	400				
	HUC 铁芯高载重聚氨酯 Heavy Duty Polyurethan Tread Cast Iron Core	6203 深沟球轴承 6203 Deep Groove Ball Bearing	600	48				
			UA 铁芯聚氨酯 Polyurethane Tread Cast Aluminum Core	6203 深沟球轴承 6203 Deep Groove Ball Bearing				
	TPU 塑料芯聚氨酯 Polyurethane Tread Plastic Core	滚针轴承 Roller Bearing	400	50				
			6202 深沟球轴承 6202 Deep Groove Ball Bearing	400				
	PVC 塑料芯PVC PVC Tread Plastic Core	滚针轴承 Roller Bearing	200	50				
	TPE 塑料芯TPE TPE Tread Plastic Core	6202 深沟球轴承 6202 Deep Groove Ball Bearing	300	50				
	FR 发泡橡胶 Foaming Rubber Tread Plastic Core	6202 深沟球轴承 6202 Deep Groove Ball Bearing	240	50				
	PP PP塑料 PP Plastic	6203 深沟球轴承 6203 Deep Groove Ball Bearing	200	50				
	NV 尼龙 Nylon	6203 深沟球轴承 6203 Deep Groove Ball Bearing	250	50				
	RC 橡胶 Rubber Tread Cast Iron Core	滚针轴承 Roller Bearing	230	47				
	SS 铸钢轮 Steel	滚针轴承 Roller Bearing	450	50				

HEAVY DUTY CASTERS/重型脚轮 TQ-40 (320-400KG)



TQ40 R-A1 UA
Rigid定向



TQ40 S-A1 UA
Swivel转向



TQ40 S BK-A1 UA
Side Lock Brake侧锁

Usage Warehouse logistics, automobile industry, machinery manufacturing and other industries handling equipment, tooling tools and logistics trolley.
用途 仓储物流、汽车工业、机械制造等行业搬运器具、工装工具和物流台车用。

STEERING STRUCTURE DIAGRAM/ 避震图

Double steel-ball track, more stable and strong;
双层钢球轨道，更加稳定和坚固。

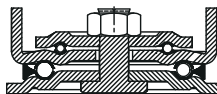

PLATE/底座

Please refer to the attachment for more mounting detail of plate bracket.
更多安装和安装力请参考附件，谢谢。

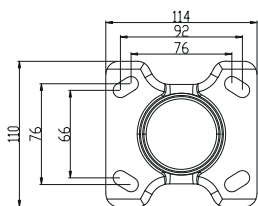

Rigid 定向底座

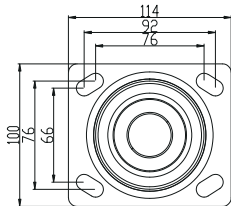

Swivel 转向底座

HEAVY DUTY CASTERS/重型脚轮 TQ-40 (320-400KG)



OPTIONS/可选项

WHEEL/轮子



UA
铝芯聚氨酯
Polyurethane Tread Cast
Aluminum Core

BEARING/轴承



6203 Deep Groove Ball Bearing
6203 深沟球轴承

PRODUCT DATA/产品数据

规格 Size in(mm)	材质 Wheel Type	轴承种类 Bearing	承重 Load Capacity kg	轮宽 Tread Width mm	总高度 Overall Height mm	旋转半径 Swivel Radius	
						转向 Swivel mm	侧刹 Brake mm
4(100)	UA	6203 深沟球轴承 6203 Deep Groove Ball Bearing	320	50	143	96	96
5(125)			360	50	165	111	111
6(150)			360	50	190.5	126	126
8(200)			400	50	241	154	154

HEAVY DUTY CASTERS/重型脚轮 DS-42 (220-800KG)



DS42 R.A1 UC
Rigid定向



DS42 S.A1 UC
Swivel转向



DS42 S.BK.A1 UC
Side Lock Brake侧刹

Usage 用途 Warehouse logistics, automobile industry, machinery manufacturing and other industries handling equipment, tooling tools and logistics trolley. 仓储物流、汽车工业、机械制造等行业搬运器具、工装工具和物流台车用。

STEERING STRUCTURE DIAGRAM/滚盘图

Double steel-ball track, more stable and strong.
双层钢球轨道，更加稳定和坚固；

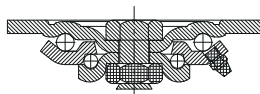

PLATE/底板

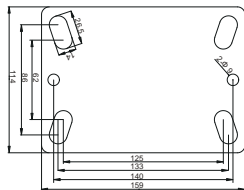

Rigid 刚性底板

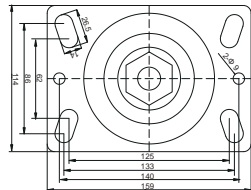

Swivel 转向底板

HEAVY DUTY CASTERS/重型脚轮 DS-42 (220-800KG)



Waterproof 防水 Labor-saving 省力 Wheelproof 耐磨

OPTIONS/可选项

WHEEL/轮子



UC 铁芯聚氨酯
Polyurethane Tread Cast Iron Core



RC 橡胶轮胎
Rubber Tread Cast Iron Core

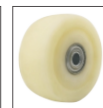

NY 尼龙
Nylon

BEARING/轴承



6204 Deep Groove Ball Bearing
6204 深沟球轴承

BRACKET/支架



Galvanized Bracket
镀锌支架



SS304 Bracket
304不锈钢支架

PRODUCT DATA/产品数据

规格 Size in(mm)	材质 Wheel Type	轴承种类 Bearing	KG 承重 Load Capacity kg	轮宽 Tread Width mm	总高度 Overall Height mm	旋转半径 Swivel Radius	
						转向 Swivel mm	侧刹 Brake mm
6(152)	UC 铁芯聚氨酯 Polyurethane Tread Cast Iron Core	6204深沟球轴承 6204 Deep Groove Ball Bearing	450	60	194	115	131
	RC 橡胶轮胎 Rubber Tread Cast Iron Core		220	60			
	NY 尼龙 Nylon		600	60			
8(203)	UC 铁芯聚氨酯 Polyurethane Tread Cast Iron Core		550	60	245	156.5	156.5
	RC 橡胶轮胎 Rubber Tread Cast Iron Core		270	60			
	NY 尼龙 Nylon		700	60			
10(254)	UC 铁芯聚氨酯 Polyurethane Tread Cast Iron Core	650	60	292	199	199	
	RC 橡胶轮胎 Rubber Tread Cast Iron Core	320	60				
	NY 尼龙 Nylon	800	60				

HEAVY DUTY CASTERS/重型脚轮 DS-45 (450-600KG)



DS45 R.A1 HUC
Rigid定向



DS45 S.A1 HUC
Swivel转向



DS45 S.BK.A1 HUC
Side Lock Brake侧刹

Usage
用途

All kinds of heavy material handling equipments and carts in many industries.
用于各种重物搬运工具, 各种工业生产工厂的搬运车等。

STEERING STRUCTURE DIAGRAM/结构图

Support bearing rotation, more stable and strong.
支架轴承转动, 更加稳定和坚固;

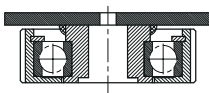

PLATE/底板

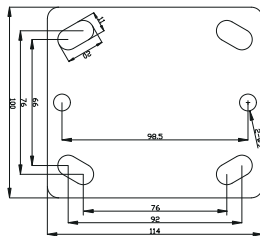

HEAVY DUTY CASTERS/重型脚轮 DS-45 (450-600KG)



OPTIONS/可选项

WHEEL/轮子

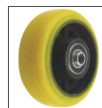

HUC
铁芯高载重聚氨酯
Tread Cast Iron Core

BEARING/轴承



6203 Deep Groove Ball Bearing
6203 深沟球轴承

N203EM
圆柱滚子轴承

PRODUCT DATA/产品数据

规格 Size in(mm)	材质 Wheel Type	轴承种类 Bearing	KG	轮宽	总高度	旋转半径	
			承重 Load Capacity kg	Tread Width mm	Overall Height mm	转向 Swivel mm	侧刹 Brake mm
4(102)	HUC 铁芯高载重聚氨酯 Heavy Duty Polyurethane Tread Cast Iron Core	6203 深沟球轴承 6203 Deep Groove Ball Bearing	450	48	143	80	141
5(127)			500	48	166	97	155
6(152)			550	48	188	114	169
			580	50	188	114	169
8(203)			600	48	241	152.5	197

HEAVY DUTY CASTERS/重型脚轮 DS-50(650-1500KG)



DS50(2.0吋) R.1 HUC
Rigid定向

DS50(2.0吋) S.1 HUC
Swivel转向

DS50(2.0吋) S.BK.1 HUC
Side Lock Brake/侧刹

**Usage
用途**

All kinds of super heavy handling equipments; overweight trailers; heavy storage equipments; heavy automobile frame; heavy field work platform; special equipments. 各种超重型物料搬运器具, 超重型车、工架车、超重型仓储设备、重型车架、重型野分作业平台等专用, 特殊设备专用。

STEERING STRUCTURE DIAGRAM/ 滚盘图

Double bearing structure, more stable and strong; 双轴承结构, 更加稳定和坚固;

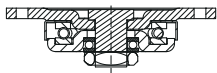

SWIVEL LOCK/方向锁

Swivel lock: change the orientation of universal 方向锁: 让方向变定向;

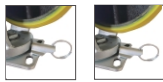

PLATE/盖板

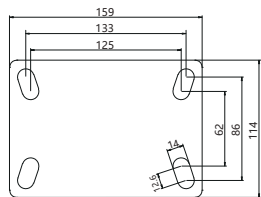

Rigid 定向底板

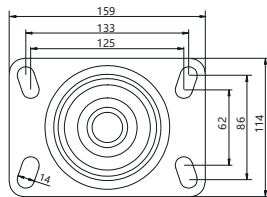

Swivel 转向底板

HEAVY DUTY CASTERS/重型脚轮 DS-50(650-1500KG)



OPTIONS/可选项

WHEEL/轮子



HUC
铁芯聚氨酯脚轮
Heavy Duty Polyurethane
Tread Cast Iron Core



UC
铁芯聚氨酯脚轮
Polyurethane Tread Cast
Iron Core



NY
尼龙
Nylon

BEARING/轴承



6205 Deep Groove
Ball Bearing
6205 深沟球轴承



N205EM
圆锥滚子轴承

PRODUCT DATA/产品数据

规格 Size in(mm)	材质 Wheel Type	轴承种类 Bearing	KG 承重 Load Capacity	轮宽 Tread Width	总高度 Overall Height	旋转半径 Swivel Radius		
			kg	mm	mm	转向 Swivel mm	侧刹 Brake mm	
4(101)	HUC	铁芯聚氨酯脚轮 Heavy Duty Polyurethane Tread Cast Iron Core	N205EM 圆锥滚子轴承	700	64	142	86	98.5
	UC	铁芯聚氨酯脚轮 Polyurethane Tread Cast Iron Core	6205 深沟球轴承 6205 Deep Groove Ball Bearing	650				
	NY	尼龙 Nylon	6205 深沟球轴承 6205 Deep Groove Ball Bearing	700				
5(127)	HUC	铁芯聚氨酯脚轮 Heavy Duty Polyurethane Tread Cast Iron Core	N205EM 圆锥滚子轴承	800	64	165	107.5	108
	UC	铁芯聚氨酯脚轮 Polyurethane Tread Cast Iron Core	6205 深沟球轴承 6205 Deep Groove Ball Bearing	680				
	NY	尼龙 Nylon	6205 深沟球轴承 6205 Deep Groove Ball Bearing	800				
6(152)	HUC	铁芯聚氨酯脚轮 Heavy Duty Polyurethane Tread Cast Iron Core	N205EM 圆锥滚子轴承	1000	64	190	130	131
	UC	铁芯聚氨酯脚轮 Polyurethane Tread Cast Iron Core	6205 深沟球轴承 6205 Deep Groove Ball Bearing	720				
	NY	尼龙 Nylon	6205 深沟球轴承 6205 Deep Groove Ball Bearing	900				
8(203)	HUC	铁芯聚氨酯脚轮 Heavy Duty Polyurethane Tread Cast Iron Core	N205EM 圆锥滚子轴承	1500	64	256	154.5	160.5
	UC	铁芯聚氨酯脚轮 Polyurethane Tread Cast Iron Core	6205 深沟球轴承 6205 Deep Groove Ball Bearing	770				
	NY	尼龙 Nylon	N205EM 圆锥滚子轴承	1000				
10(254)	HUC	铁芯聚氨酯脚轮 Heavy Duty Polyurethane Tread Cast Iron Core	N205EM 圆锥滚子轴承	1500	64	302	197	197
	UC	铁芯聚氨酯脚轮 Polyurethane Tread Cast Iron Core	6205 深沟球轴承 6205 Deep Groove Ball Bearing	820				
	NY	尼龙 Nylon	N205EM 圆锥滚子轴承	1200				
12(304)	HUC	铁芯聚氨酯脚轮 Heavy Duty Polyurethane Tread Cast Iron Core	N205EM 圆锥滚子轴承	1500	64	353	234	237.5
	UC	铁芯聚氨酯脚轮 Polyurethane Tread Cast Iron Core	6205 深沟球轴承 6205 Deep Groove Ball Bearing	1000				
	NY	尼龙 Nylon	N205EM 圆锥滚子轴承	1200				

HEAVY DUTY CASTERS/重型脚轮 DS-70 (3000-6000KG)

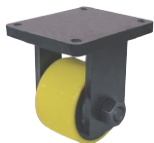

DS70 R A1 HUC
Rigid定向



DS70 S A1 HUC
Swivel转向



DS70 S BK A1 HUC
Side Lock Brake侧刹

Usage 用途

Super heavy turnover equipments; unload equipment for ports; high load equipment.
高强度的承载、超重载重量的周转器具，港口卸载设备，高荷载设备。

STEERING STRUCTURE DIAGRAM/滚盘图

Double steel-ball track, more stable and strong;
双层钢球轨道，更加稳定和坚固；

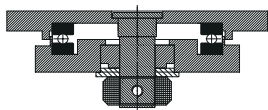

PLATE/底板

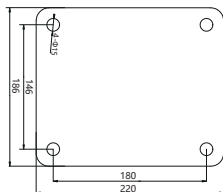

Rigid 定向底板

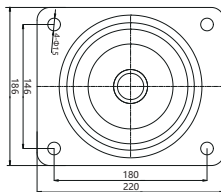

Swivel 转向底板

HEAVY DUTY CASTERS/重型脚轮 DS-70 (3000-6000KG)



Waterproof 防水 Labor-saving 省力 Wheelproof 耐磨

OPTIONS/可选项

WHEEL/轮子



HUC
铁芯高载重聚氨酯
Heavy Duty Polyurethane
Tread Cast Iron Core

BEARING/轴承



NI2306M
圆柱滚子轴承

PRODUCT DATA/产品数据

规格 Size	材质 Wheel Type	轴承种类 Bearing	承重 Load Capacity	轮宽 Tread Width	总高度 Overall Height	旋转半径 Swivel Radius		
			kg	mm	mm	转向 Swivel mm	侧刹 Brake mm	定向侧刹 Swivel mm
6(150)	HUC 铁芯高载重聚氨酯 Heavy Duty Polyurethane Tread Cast Iron Core	NI2306M 圆柱滚子轴承	3000	100	230	126	232	219
8(200)			4000	100	285	151	252	245
10(250)			5000	100	340	177	275	270
12(300)			6000	100	390	202	295	296

SHOCK ABSORBING CASTERS/缓冲减震脚轮 DS-91 (1000-1500KG)



DS91 R A1 HUC
Rigid定向



DS91 S A1 HUC
Swivel转向



DS91 S BK-A1 HUC
Side Lock Brake侧刹

**Usage
用途**

Heavy duty handling equipment that need shock absorption, auto parts handling equipment, other heavy duty transport equipment that need shock absorption.
载重量大的需减震的搬运器具, 汽车等配件搬运器具, 其他重型运输需要缓冲减震的搬运器具。

STEERING STRUCTURE DIAGRAM/滚盘图

Double steel-ball track, more stable and strong;
双层钢球轨道, 更加稳定和坚固;

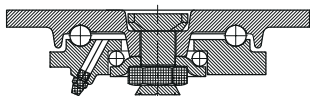

PLATE/底板

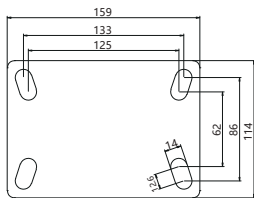

Rigid 定向底板

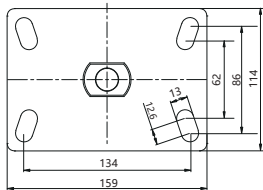

Swivel 转向底板

SHOCK ABSORBING CASTERS/缓冲减震脚轮 DS-91 (1000-1500KG)



OPTIONS/可选项

WHEEL/轮子

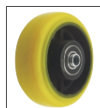

HUC
铁芯高载重聚氨酯
Tread Cast Iron Core

BEARING/轴承



N1205EM
圆柱滚子轴承

PRODUCT DATA/产品数据

规格 Size in(mm)	材质 Wheel Type		轴承种类 Bearing	KG	轮宽	总高度	旋转半径	
				承重 Load Capacity	Tread Width	Overall Height	转向 Swivel	侧刹 Brake
				kg	mm	mm	mm	mm
6(152)		HUC 铁芯高载重聚氨酯 Heavy Duty Polyurethane Tread Cast Iron Core	N1205EM 圆柱滚子轴承	1000	64	203	126	209
8(202)				1500	64	260	151	227

SHOCK ABSORBING CASTERS/缓冲减震脚轮 DS-91(2.0版)(1000-1500KG)

升级
NEW



DS91 R A1 HUC
Rigid定向



DS91 S A1 HUC
Swivel转向



DS91 S BK A1 HUC
Side Lock Brake侧刹

Usage
用途

Heavy duty handling equipment that need shock absorption, auto parts handling equipment, other heavy duty transport equipment that need shock absorption.
载重量大的需减震的搬运器具, 汽车等配件搬运器具, 其他重型运输需要缓冲减震的搬运器具。

STEERING STRUCTURE DIAGRAM/滚道图

Double bearing structure, more stable and strong;
双轴承结构, 更加稳定和牢固;

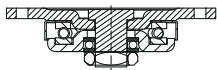

SWIVEL LOCK/方向锁

Swivel lock: change the orientation of universal
方向锁: 让万向变定向;

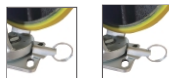

Locking
锁止状态

Opening
松开状态

PLATE/滚板

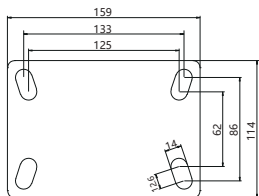

Rigid 定向滚板

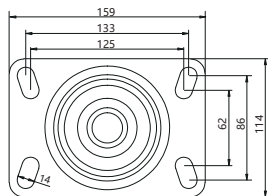

Swivel 转向滚板

SHOCK ABSORBING CASTERS/缓冲减震脚轮 DS-91(2.0版)(1000-1500KG)

升级
NEW



OPTIONS/可选项

WHEEL/轮子

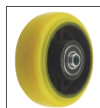

HUC
铁芯高耐磨聚氨酯
Heavy Duty Polyurethane
Tread Cast Iron Core

BEARING/轴承



N205EM
圆柱滚子轴承

PRODUCT DATA/产品数据

规格 Size	材质 Wheel Type	轴承种类 Bearing	KG	轴承	轮宽	总高度	旋转半径	
			Load Capacity	Tread Width	Overall Height	转向 Swivel	侧刹 Brake	
in(mm)			kg	mm	mm	mm	mm	mm
6(152)	HUC	铁芯高耐磨聚氨酯 Heavy Duty Polyurethane Tread Cast Iron Core	1000	64	203	126	209	
8(202)			N205EM 圆柱滚子轴承	1500	64	260	151	227

SHOCK ABSORBING CASTERS/缓冲减震脚轮 DS-93 (320-400KG)



DS93 RA1 UC
Rigid定向



DS93 S.A1 UC
Swivel转向



DS93 S.BK.A1 UC
Side Lock Brake侧刹

Usage
用途

Heavy duty handling equipment that need shock absorption, auto parts handling equipment, logistics cars with traction power, other equipment that need reduce noise.
高强度搬运设备，汽车零部件搬运车辆，需要动力牵引的物流周转车，容易受到噪音影响的设备及制造搬运设备。

STEERING STRUCTURE DIAGRAM/滚盘图

Double steel-ball track, more stable and strong.
双层钢球轨道，更加稳定和坚固。

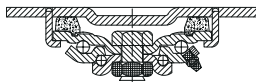

PLATE/底板

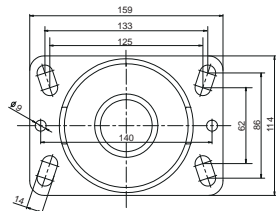

Rigid 定向底板

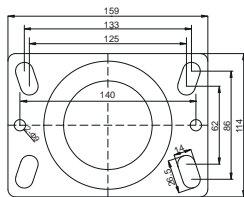

Swivel 转向底板

SHOCK ABSORBING CASTERS/缓冲减震脚轮 DS-93 (320-400KG)



Waterproof 防水 Labor-saving 省力 Wearproof 耐磨

OPTIONS/可选项

WHEEL/轮子



UC
铁芯聚氨酯胎
Cast Iron Core

BEARING/轴承



Deep Groove Ball Bearing
深沟球轴承

PRODUCT DATA/产品数据

规格 Size	材质 Wheel Type	轴承种类 Bearing	KG	轮宽	总高度	旋转半径	
			Load Capacity	Tread Width	Overall Height	转向 Swivel	侧刹 Brake
in/mm			kg	mm	mm	mm	mm
4(102)	UC	6201深沟球轴承 6201 Deep Groove Ball Bearing	320	48	157.5	81	93.5
		6203 深沟球轴承 6203 Deep Groove Ball Bearing	320	48			
5(127)		6201 深沟球轴承 6201 Deep Groove Ball Bearing	340	48	180	98	98
		6203 深沟球轴承 6203 Deep Groove Ball Bearing	360	48			
6(152)		6201 深沟球轴承 6201 Deep Groove Ball Bearing	360	48	204	115	115
		6203 深沟球轴承 6203 Deep Groove Ball Bearing	360	48			
8(203)	6201 深沟球轴承 6201 Deep Groove Ball Bearing	400	48	256	152	152	
	6203 深沟球轴承 6203 Deep Groove Ball Bearing	400	48				

SHOCK ABSORBING CASTERS/缓冲减震脚轮 DS-94 (250-480KG)



DS94 RA1 UC
Rigid定向



DS94 S.A1 UC
Swivel转向



DS94 S.BK A1 UC
Side Lock Brake侧刹

Usage 用途

Heavy duty handling equipment that need shock absorption, auto parts handling equipment, logistics cars with traction power, other equipment that need reduce noise.
高载重的搬运器具；汽车零部件搬运器具；需要动力牵引的物流周转车；容易受到噪音影响的设备及制造业运输车辆。

STEERING STRUCTURE DIAGRAM/ 避震图

Double steel-ball track, more stable and strong;
双钢球轨道，更加稳定和坚固；

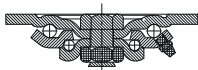

SWIVEL LOCK/方向锁

Swivel lock: change the orientation of universal
方向锁：让方向变定向；



Locking
锁止状态

Opening
松开状态

PLATE/底板

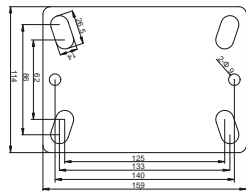

Rigid 定向底板

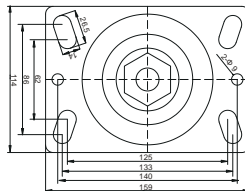

Swivel 转向底板

SHOCK ABSORBING CASTERS/缓冲减震脚轮 DS-94 (250-480KG)



Waterproof 防水 Labor-saving 省力 Wearproof 耐磨

OPTIONS/可选项

WHEEL/轮子



UC
铁芯聚氨酯
Polyurethane Tread
Cast Iron Core



UA
铝芯聚氨酯
Polyurethane Tread
Cast Aluminum Core

BEARING/轴承



6203 Deep Groove Ball Bearing
6203 深沟球轴承

PRODUCT DATA/产品数据

规格 Size in(mm)	材质 Wheel Type	轴承种类 Bearing	KG Load Capacity kg	轮宽 Tread Width mm	总高度 Overall Height mm	旋转半径 Swivel Radius	
						转向 Swivel mm	侧刹 Brake mm
5(126)	UC 铁芯聚氨酯 Polyurethane Tread Cast Iron Core	6201 深沟球轴承 6201 Deep Groove Ball Bearing	250	48	187	113	198
		6203 深沟球轴承 6203 Deep Groove Ball Bearing	270	48	187	113	198
	UA 铝芯聚氨酯 Polyurethane Tread Cast Aluminum Core	6203 深沟球轴承 6203 Deep Groove Ball Bearing	400	50	187	113	198
		6201 深沟球轴承 6201 Deep Groove Ball Bearing	320	44	200	126	208
6(152)	UC 铁芯聚氨酯 Polyurethane Tread Cast Iron Core	6201 深沟球轴承 6201 Deep Groove Ball Bearing	330	48	200	126	208
		6203 深沟球轴承 6203 Deep Groove Ball Bearing	340	44	200	126	208
		6203 深沟球轴承 6203 Deep Groove Ball Bearing	350	48	200	126	208
		6203 深沟球轴承 6203 Deep Groove Ball Bearing	350	48	200	126	208
	UA 铝芯聚氨酯 Polyurethane Tread Cast Aluminum Core	6203 深沟球轴承 6203 Deep Groove Ball Bearing	450	50	200	126	208
		6201 深沟球轴承 6201 Deep Groove Ball Bearing	450	48	252	177	254
8(203)	UC 铁芯聚氨酯 Polyurethane Tread Cast Iron Core	6201 深沟球轴承 6201 Deep Groove Ball Bearing	450	48	252	177	254
		6203 深沟球轴承 6203 Deep Groove Ball Bearing	450	48	252	177	254
	UA 铝芯聚氨酯 Polyurethane Tread Cast Aluminum Core	6203 深沟球轴承 6203 Deep Groove Ball Bearing	480	50	252	177	254

SHOCK ABSORBING CASTERS/缓冲减震脚轮 DS-98 (270-350KG)



DS98 RA1 UC
Rigid定向



DS98 S.A1 UC
Swivel转向

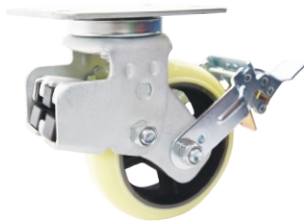

DS98 S.BK.A1 UC
Side Lock Brake侧刹

**Usage
用途**

Heavy duty handling equipment that need shock absorption, auto parts handling equipment, logistics cars with traction power, other equipment that need reduce noise.
需减震的搬运器具；汽车零部件搬运器具；需要动力牵引的物流周转车；容易受到噪音影响的设备及制造业搬运高用。

STEERING STRUCTURE DIAGRAM/滚盘图

Support double bearing relation, more stable and strong.
支架双轴承转动，更加稳定和坚固；

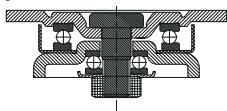

PLATE/底板

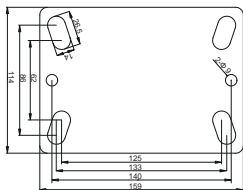

Rigid 定向底板

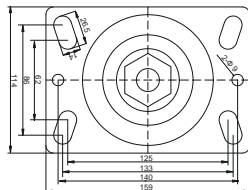

Swivel 转向底板

SHOCK ABSORBING CASTERS/缓冲减震脚轮 DS-98 (270-350KG)



Waterproof 防水 Labor-saving 省力 Wearproof 耐磨

OPTIONS/可选项

WHEEL/轮子



UC
铁芯聚氨酯
Polyurethane Tread
Cast Iron Core

BEARING/轴承



6203 Deep Groove Ball Bearing
6203 深沟球轴承

PRODUCT DATA/产品数据

规格 Size in(mm)	材质 Wheel Type	轴承种类 Bearing	KG	轮宽	总高度	总半径	
			Load Capacity kg	Tread Width mm	Overall Height mm	转向 Swivel mm	侧刹 Brake mm
5(126)	UC 铁芯聚氨酯 Polyurethane Tread Cast Iron Core	6203深沟球轴承 6203 Deep Groove Ball Bearing	270	48	187.5	113	179
6(152)			330	48	200	126	189
8(203)			450	48	252	177	235

IRON RAIL WHEEL CASTERS/轨道轮

DS-60 (80-1000KG)

FEATURES:

- Surface Treatment:** Environmental blue-white zinc plating/color;
- Wheel Color:** Black;
- Wheel Technology:** Strong cast iron;
- Usage:** Workshop railway car; rail line; rail door; equipment special components.

特点:

- 表面处理:** 环保镀锌白锌, 彩锌可定制;
- 轮子颜色:** 常规为黑色;
- 轮子工艺:** 铸造工艺, 铸铁材质, 结实耐用;
- 用途:** 车间轨道用工具车、轨道流水线, 轨道门、轨道车、设备专用部件等。



V-type Cast Iron Casters
V型铸铁轮

PRODUCT DATA/产品数据

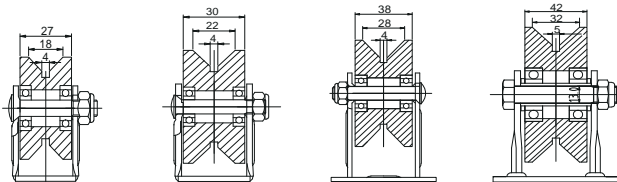

DS6020 V Caster

DS6025 V Caster

DS6030 V Caster

DS6040 V Caster

规格 Size in(mm)	材质 Wheel Type	轴承种类 Bearing	承重 Load Capacity	轮宽 Tread Width	工作尺寸 Working Dimension	底板尺寸 Plate Size	孔距 Hole Spacing	孔径 Hole Size	总高度 Overall Height	
			(kg)	(mm)		(mm)	(mm)	(mm)		(mm)
2(50)	V型铸铁 Iron	608深珠轴承 608 Ball Bearing	80	27	V开口尺寸 Openings size	18	68*38.5	53.55*24	M6	61
2.5(64)		608深珠轴承 608 Ball Bearing	100	30		22	80*41	64*26.5	M6	74
3(76)		600深珠轴承 600 Ball Bearing	150	38		28	95*70	75.5*44	M8	101
4(101)		6203深珠轴承 6203 Ball Bearing	400	42		32	95*85	77*58	M8	116
4(101)		6203深珠轴承 6203 Ball Bearing	1000	42		32	100*114	71*84	M10	142

IRON RAIL WHEEL CASTERS/轨道轮

DS-60 (80-1000KG)

FEATURES:

- Surface Treatment:** Environmental blue-white zinc plating/color;
- Wheel Color:** Black;
- Wheel Technology:** Strong cast iron;
- Usage:** Workshop railway car; rail line; rail door; equipment special components.

特点:

- 表面处理:** 环保镀锌白锌, 彩锌可定制;
- 轮子颜色:** 常规为黑色;
- 轮子工艺:** 铸造工艺, 铸铁材质, 结实耐用;
- 用途:** 车间轨道用工具车、轨道流水线, 轨道门、轨道车、设备专用部件等。



U-type Cast Iron Casters
U型铸铁轮

PRODUCT DATA/产品数据

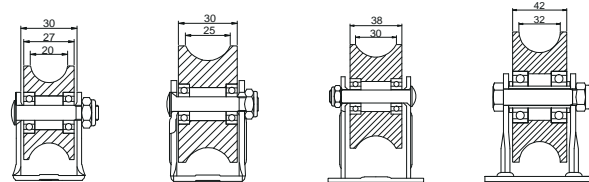

DS6020 U Caster

DS6025 U Caster

DS6030 U Caster

DS6040 U Caster

规格 Size in(mm)	材质 Wheel Type	轴承种类 Bearing	承重 Load Capacity	轮宽 Tread Width	U型宽度 U Width	U型深度 U Depth	底板尺寸 Plate Size	孔距 Hole Spacing	孔径 Hole Size	总高度 Overall Height
			(kg)	(mm)	(mm)	(mm)	(mm)	(mm)	(mm)	
2(50)	U型铸铁 Iron	608深珠轴承 608 Ball Bearing	80	27	20	9	68*38.5	53.55*24	M6	61
2.5(64)		608深珠轴承 608 Ball Bearing	100	30	25	7.5	80*41	64*26.5	M6	74
3(76)		600深珠轴承 600 Ball Bearing	150	38	30	9.3	95*70	75.5*44	M8	101
4(101)		6203深珠轴承 6203 Ball Bearing	400	42	32	16	95*85	77*58	M8	116
4(101)		6203深珠轴承 6203 Ball Bearing	1000	42	32	16	100*114	71*84	M10	142

ANTI STATIC CASTERS / 导电轮 DS-20 (10³-10¹¹ Ω·m)

RESISTIVITY:

Conductive wheel resistivity: 10³-10⁵ Ω·m;

Resistivity of anti-static wheel: 10⁶-10¹¹ Ω·m;

电阻率:

导电轮电阻率: 10³-10⁵ Ω·m;

防静电轮电阻率: 10⁶-10¹¹ Ω·m;



Conductive Casters
导电轮

OPTIONAL WHEEL TYPE/轮子材质可选



TPE
弹性体热塑性
TPE Tread Plastic Core

TPU
弹性体聚氨酯
Polyurethane Tread Plastic Core

PP
聚丙烯
PP Plastic

NY
尼龙
Nylon

LEVELING ADJUSTABLE CASTERS / 水平调节轮 DS-80 (250-1000KG)



Stamping Square Plate Adjustable Leveling Casters
冲压式方形板水平调节轮

FEATURES:

Shell Material: Pressure casting aluminum alloy; strong compressive; high strength;

Wheel Material: Nylon;

Level Adjustment Pedestal: Made up of synthetic rubber, corrosion protection, steady;

Swivel Construction: Double steel-ball track, more stable and flexible;

Methods of Use: Easy to switch between fixed and mobile operation by hand or wrench; great mobility and height control;

Surface Treatment: Treatment powder surface, neutral salt spray test > 300 hours;

Usage: Testing equipment; medical equipment; optical equipment; cleaning room equipment; packaging machinery; numerical control machine; precision machine; special workbench and etc.

特点:

外壳材质: 由铝合金压铸而成, 强度高抗压性更强;

轮子材料: 尼龙;

水平调节垫片: 由优质合成橡胶组成, 防腐蚀, 稳定;

回转轴部位: 双层钢球轨道, 转动更灵活;

使用方法: 通过手动或用扳手, 易于在固定和移动之间互换, 出色的移动性, 容易的高度调节控制;

表面处理: 表面喷粉处理, 耐中性盐雾试验300小时以上;

用途: 检测设备, 医疗设备, 光学设备, 洁净室设备, 包装机械, 数控机床, 精密机床, 特殊工作台等。

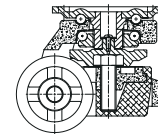

Profile
剖面图

PRODUCT DATA / 产品数据

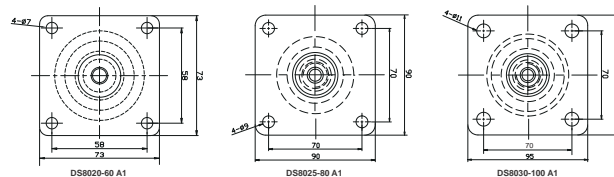

规格 Size	材质 Wheel Type	轮宽 Tread Width	承重 Load Capacity	总高度 Overall Height	可调高度 Adjustable height	孔径 Hole Size
in(mm)		(mm)	(kg)	(mm)	(mm)	(mm)
2.5(63)	尼龙 Nylon	24	250	82	10.8	7
3(75)		29	600	102	15	9
		30.3	1000	120	12	11

LEVELING ADJUSTABLE CASTERS/水平调节轮 DS-80 (250-1000KG)

FEATURES:

Shell Material: Pressure casting aluminum alloy; strong compressive; high strength;

Wheel Material: Nylon;

Level Adjustment Pedestal: Made up of synthetic rubber, corrosion protection, steady;

Swivel Construction: Double steel-ball track, more stable and flexible;

Methods of Use: Easy to switch between fixed and mobile operation by hand or wrench; great mobility and height control;

Surface Treatment: Treatment powder surface, neutral salt spray test > 300 hours;

Usage: Testing equipment; medical equipment; optical equipment; cleaning room equipment; packaging machinery; numerical control machine; precision machine; special workbench and etc.

特点:

外壳材质: 由铝合金压铸而成, 强度高抗压性更强;

轮子材料: 尼龙;

水平调节垫片: 由优质合成橡胶组成, 防腐蚀, 稳定;

回弹部位: 双层钢球轨道, 转动更灵活;

使用方法: 通过手动或用扳手, 易于在固定和移动之间互换, 出色的移动性, 容易的高度调节控制;

表面处理: 表面喷粉处理, 耐中性盐雾试验300小时以上;

用途: 检测设备, 医疗设备, 光学设备, 洁净室设备, 包装机械, 数控机床, 精密机床, 特殊工作台等。



Drop Forged Square Plate Adjustable Leveling Casters
锻造式调平水平调节轮

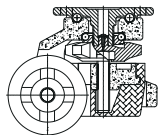

Profile
剖面图

PRODUCT DATA/产品数据

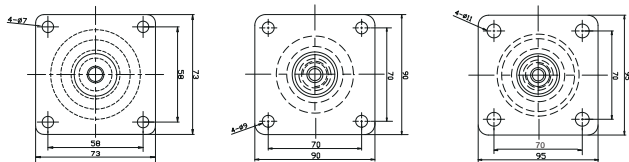

规格 Size	材质 Wheel Type	轮宽 Tread Width	承重 Load Capacity	总高度 Overall Height	可调高度 Adjustable height	孔径 Hole Size
in(mm)		(mm)	(kg)	(mm)	(mm)	(mm)
2(50)	尼龙 Nylon	24	250	82	10.8	7
2.5(63)		29	600	102	15	9
3(75)		30.3	1000	120	12	11

LEVELING ADJUSTABLE CASTERS/水平调节轮 DS-80 (250-1000KG)

FEATURES:

Shell Material: Pressure casting aluminum alloy; strong compressive; high strength;

Wheel Material: Nylon;

Level Adjustment Pedestal: Made up of synthetic rubber, corrosion protection, steady;

Swivel Construction: Double steel-ball track, more stable and flexible;

Methods of Use: Easy to switch between fixed and mobile operation by hand or wrench; great mobility and height control;

Surface Treatment: Treatment powder surface, neutral salt spray test > 300 hours;

Usage: Testing equipment; medical equipment; optical equipment; cleaning room equipment; packaging machinery; numerical control machine; precision machine; special workbench and etc.

特点:

外壳材质: 由铝合金压铸而成, 强度高抗压性更强;

轮子材料: 尼龙;

水平调节垫片: 由优质合成橡胶组成, 防腐蚀, 稳定;

回弹部位: 双层钢球轨道, 转动更灵活;

使用方法: 通过手动或用扳手, 易于在固定和移动之间互换, 出色的移动性, 容易的高度调节控制;

表面处理: 表面喷粉处理, 耐中性盐雾试验300小时以上;

用途: 检测设备, 医疗设备, 光学设备, 洁净室设备, 包装机械, 数控机床, 精密机床, 特殊工作台等。

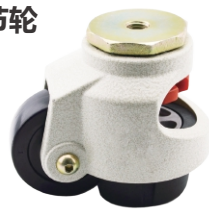

Swivel Leveling Adjustable Casters
旋转式水平调节轮

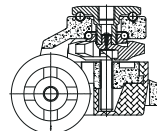

Profile
剖面图

PRODUCT DATA/产品数据

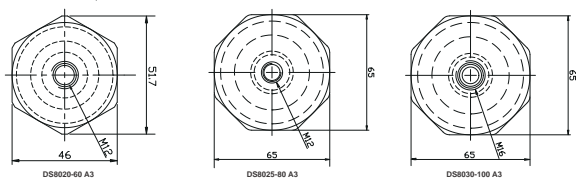

规格 Size	材质 Wheel Type	轮宽 Tread Width	承重 Load Capacity	总高度 Overall Height	可调高度 Adjustable height	孔径 Hole Size
in(mm)		(mm)	(kg)	(mm)	(mm)	(mm)
2(50)	尼龙 Nylon	24	250	82	10.8	12
2.5(63)		29	600	102	15	12
3(75)		30.3	1000	120	12	16

STAINLESS STEEL CASTERS / 不锈钢脚轮

DS-20 (80-180KG)



DS20 R.A1 TPU
Rigid定向

DS20 S.A1 TPU
Swivel转向

DS20 S.SWB.A1 TPU
Dual Lock Brake双刹

DS20 S.BK.A1 TPU
Side Lock Brake侧刹

Usage 用途

Industrial custodian car; small handling equipment; all kinds of light duty handling equipment.
各种工业用保管台车, 小型搬运设备, 各种轻型物品搬运器具等。

STEERING STRUCTURE DIAGRAM / 滚盘图

Double steel-ball track, more stable and strong;
双层钢球轨道, 更加稳定和牢固;

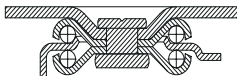
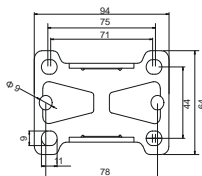
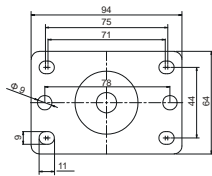

PLATE / 底板

Please refer to the attachment for more mounting data details of plate brackets.
更多平板支架安装方式的数值尺寸, 详见附件



Rigid 定向底板



Swivel 转向底板

STAINLESS STEEL CASTERS / 不锈钢脚轮

DS-20 (80-180KG)



OPTIONS / 可选项

WHEEL / 轮子



NY
Nylon
尼龙

PP
PP塑料
PP Plastic

BRACKET / 支架

BRACKET MATERIAL / 支架材质



Galvanized Bracket
镀锌支架

SS304 Bracket
304不锈钢支架

PRODUCT DATA / 产品数据

规格 Size in(mm)	材质 Wheel Type	轴承种类 Bearing	KG	轮宽	总高度	轴杆半径		
			Load Capacity	Tread Width	Overall Height	转向 Swivel	侧刹 Brake	双刹 Dual Lock Brake
			kg	mm	mm	mm	mm	mm
3(76)	尼龙 Nylon	螺栓 Rivet Bearing	120	32	101	72	76	117
	超重型塑料 Super Heavy Duty Plastic		135	31				
4(100)	尼龙 Nylon		145	32	127	85.5	90	117
	超重型塑料 Super Heavy Duty Plastic		170	31				
5(127)	尼龙 Nylon		165	32	157	101.5	101.5	117
	超重型塑料 Super Heavy Duty Plastic		180	31				

STAINLESS STEEL CASTERS/不锈钢脚轮

DS-40 (100-400KG)



DS40 R A1 TPU
Rigid定向



DS40 S A1 TPU
Swivel转向



DS40 S S.W.B.A1 TPU
Dual Lock Brake双刹



DS40 S B.K.A1 TPU
Side Lock Brake侧刹

Usage 用途 Warehouse logistics, automobile industry, machinery manufacturing and other industries handling equipment, tooling tools and logistics trolley.
仓储物流, 汽车工业, 机械制造等行业搬运器具, 工装工具和物流台车用。

STEERING STRUCTURE DIAGRAM/滚盘图

Double steel-ball track, more stable and strong;
双层钢球轨道, 更加稳定和坚固;

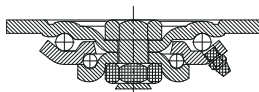

PLATE/底座

Please refer to the attachment for more mounting data details of plate bracket
更多安装数据请参考附件, 详细规格。

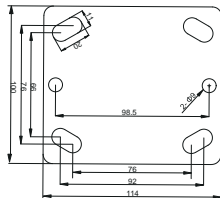

Rigid 定向底座

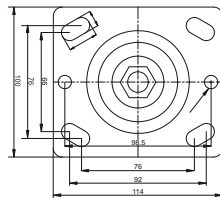

Swivel 转向底座

STAINLESS STEEL CASTERS/不锈钢脚轮

DS-40 (100-400KG)



OPTIONS/可选项

WHEEL/轮子

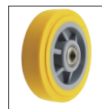

TPU
聚氨酯轮盘
Polyurethane Tread Plastic Core



NY
尼龙
Nylon

BEARING/轴承



Deep Groove Ball Bearing
深沟球轴承

BRACKET/支架



Galvanized Stents
镀锌支架



SS304 Bracket
304不锈钢支架

PRODUCT DATA/产品数据

规格 Size in(mm)	材质 Wheel Type	轴承种类 Bearing	KG	轮宽	总高度	旋转半径		
			承重 Load Capacity kg	Tread Width mm	Overall Height mm	转向 Swivel mm	侧刹 Brake mm	双刹 Dual Lock Brake mm
4(101)	TPU 聚氨酯轮盘 Polyurethane Tread Plastic Core	6202 深沟球轴承 Ball Bearing	250	50	143	80.5	93.5	141
	NY 尼龙 Nylon	6203 深沟球轴承 Ball Bearing	150	50				
5(126)	TPU 聚氨酯轮盘 Polyurethane Tread Plastic Core	6202 深沟球轴承 Ball Bearing	300	50	166	97	97	143
	NY 尼龙 Nylon	6203 深沟球轴承 Ball Bearing	150	50				
6(152)	TPU 聚氨酯轮盘 Polyurethane Tread Plastic Core	6202 深沟球轴承 Ball Bearing	350	50	188	114	114	144
	NY 尼龙 Nylon	6203 深沟球轴承 Ball Bearing	200	50				
8(203)	TPU 聚氨酯轮盘 Polyurethane Tread Plastic Core	6202 深沟球轴承 Ball Bearing	400	50	241	152.5	152.5	152.5
	NY 尼龙 Nylon	6203 深沟球轴承 Ball Bearing	250	50				

HIGH TEMPERATURE CASTERS / 耐高温脚轮

DS-20 (70-140KG)



DS20 R.A1 TPU
Rigid定向

DS20 S.A1 TPU
Swivel转向

DS20 S.BK.A1 TPU
Side Lock Brake侧刹

DS20 S.SWB.A1 TPU
Dual Lock Brake双刹

Usage 用途

Industrial custodian car; small handling equipment; all kinds of light duty handling equipment.
各种工业用保管台车, 小型搬运设备, 各种轻型物品搬运器具等。

STEERING STRUCTURE DIAGRAM / 滚盖图

Double steel-ball track, more stable and strong;
双层钢球轨道, 更加稳定和坚固;

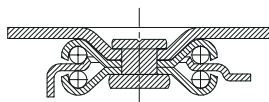
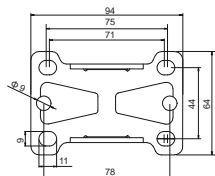
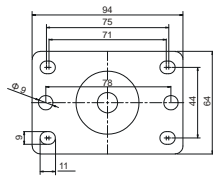

PLATE / 底板

Please refer to the attachment for more mounting data details of plate bracket.
更多平板支架安装方式的数据尺寸, 详见附表



Rigid 定向底板



Swivel 转向底板

HIGH TEMPERATURE CASTERS / 耐高温脚轮

DS-20 (70-140KG)



OPTIONS / 可选项

WHEEL / 轮子



PH260°C
Phenolic Wheel
酚醛轮盖

PH150°C
Phenolic Wheel
酚醛轮盖

PA280°C
Nylon and Glass Fiber
尼龙纤维

PA230°C
Nylon and Glass Fiber
尼龙纤维

BEARING / 轴承



Rivet Bearing
铆钉轴承

Deep Groove Ball Bearing
深沟球轴承

Customized Bearing
专用定制轴承

BRACKET / 支架

BRACKET MATERIAL / 支架材质



Galvanized Bracket
镀锌支架

SS304 Bracket
304不锈钢支架

More data details of bracket mounting are enclosed here for your reference.
更多详细支架安装方式的表格, 详见附表

FASTENING TYPE / 安装方式



Plate Type
平板式

Threaded Stem
螺柱式

Square Stem
四角杆式

Grip Ring Stem
卡簧杆式

Round Stem
圆柱杆式

Octagon Stem
八角杆式

Welded Pipe Stem
焊接式

Hole Top Stem
孔顶式

HIGH TEMPERATURE CASTERS/耐高温脚轮

DS-20 (70-140KG)

PRODUCT DATA/产品数据

规格 Size (in/mm)	材质 Wheel Type		轴承种类 Bearing	KG 承重 Load Capacity	轮宽 Tread Width	总高度 Overall Height	旋转半径 Swivel Radius		
				kg	mm	mm	转向 Swivel	侧刹 Brake	双刹 Dual Lock Brake
3(76)	PH260°C	酚醛耐高温 Phenolic Wheel	螺栓 Rivet Bearing	115	34	101	72	76	117
	PH150°C	酚醛耐高温 Phenolic Wheel	螺栓 Rivet Bearing	115	34	101			
	PA280°C	尼龙玻纤 Nylon and Glass Fiber	6001 深沟球轴承 6001 Deep Groove Ball Bearing	80	32	101			
	PA230°C	尼龙玻纤 Nylon and Glass Fiber	6001 深沟球轴承 6001 Deep Groove Ball Bearing	70	32	101			
4(100)	PH260°C	酚醛耐高温 Phenolic Wheel	螺栓 Rivet Bearing	130	34	126	85.5	90	117
	PH150°C	酚醛耐高温 Phenolic Wheel	螺栓 Rivet Bearing	130	34	126			
	PA280°C	尼龙玻纤 Nylon and Glass Fiber	6001 深沟球轴承 6001 Deep Groove Ball Bearing	115	32	126			
	PA230°C	尼龙玻纤 Nylon and Glass Fiber	6001 深沟球轴承 6001 Deep Groove Ball Bearing	90	32	126			
5(127)	PH260°C	酚醛耐高温 Phenolic Wheel	螺栓 Rivet Bearing	140	34	157	101.5	101.5	117
	PH150°C	酚醛耐高温 Phenolic Wheel	螺栓 Rivet Bearing	140	34	157			
	PA280°C	尼龙玻纤 Nylon and Glass Fiber	6001 深沟球轴承 6001 Deep Groove Ball Bearing	130	32	157			
	PA230°C	尼龙玻纤 Nylon and Glass Fiber	6001 深沟球轴承 6001 Deep Groove Ball Bearing	115	32	157			

HIGH TEMPERATURE CASTERS/耐高温脚轮

DS-40 (180-500KG)



Usage 用途

Warehouse logistics, automobile industry, machinery manufacturing and other industries handling equipment, tooling tools and logistics trolley, 仓储物流、汽车工业、机械制造等行业搬运器具、工装工具和物流台车用。

STEERING STRUCTURE DIAGRAM/ 滚盘图

Double steel-ball track, more stable and strong; 双层钢球轨道，更加稳定和坚固；

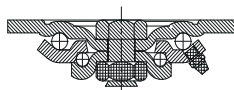

SWIVEL LOCK/方向锁

Swivel lock: change the orientation of universal 方向锁：让方向变方向；

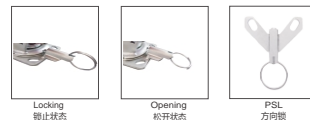

PLATE/底板

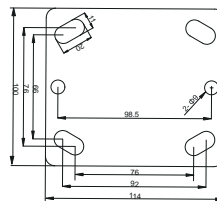

Rigid 定向底板

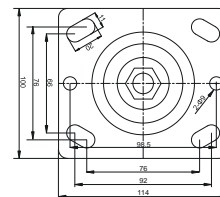

Swivel 转向底板

HIGH TEMPERATURE CASTERS / 耐高温脚轮

DS-40 (180-500KG)



Waterproof 防水 Labor-saving 省力 Wearproof 耐磨

OPTIONS/可选项

WHEEL/轮子

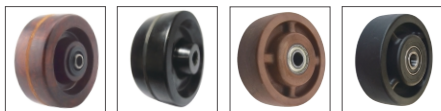

PH260*
酚醛树脂轮
Phenolic Wheel

PH150*
酚醛树脂轮
Phenolic Wheel

PA280*
尼龙玻纤
Nylon and Glass Fiber

PA230*
尼龙玻纤
Nylon and Glass Fiber

BEARING/轴承



Deep Groove Ball Bearing
深沟球轴承



Roller Bearing
滚针轴承



Roller Bearing
特鲁贝轴承

BRACKET/支架



Galvanized Stents
镀锌支架



SS304 Bracket
304不锈钢支架



Welded Pipe Stem
焊管式

More data details of bracket mounting are enclosed here for your reference.
更多详细支架安装方式的数据，请见附录

HIGH TEMPERATURE CASTERS / 耐高温脚轮

DS-40 (180-500KG)

PRODUCT DATA/产品数据

规格 Size in(mm)	材质 Wheel Type	轴承种类 Bearing	承重 Load Capacity	轮宽 Tread Width	总高度 Overall Height	旋转半径 Swivel Radius		
			kg	mm	mm	转向 Swivel	侧刹 Brake	双刹 Dual Lock Brake
4(101)	PH260* 酚醛树脂轮 Phenolic Wheel	滚针轴承 Needle Roller Bearing	350	50	143	80.5	93.5	141
	PH150* 酚醛树脂轮 Phenolic Wheel	滚针轴承 Needle Roller Bearing	350	50				
	PA280* 尼龙玻纤 Nylon and Glass Fiber	6203 深沟球轴承 6203 Deep Groove Ball Bearing	200	45				
	PA230* 尼龙玻纤 Nylon and Glass Fiber	6203 深沟球轴承 6203 Deep Groove Ball Bearing	180	45				
5(126)	PH260* 酚醛树脂轮 Phenolic Wheel	滚针轴承 Needle Roller Bearing	370	50	166	97	97	143
	PH150* 酚醛树脂轮 Phenolic Wheel	滚针轴承 Needle Roller Bearing	370	50				
	PA280* 尼龙玻纤 Nylon and Glass Fiber	6203 深沟球轴承 6203 Deep Groove Ball Bearing	250	45				
	PA230* 尼龙玻纤 Nylon and Glass Fiber	6203 深沟球轴承 6203 Deep Groove Ball Bearing	220	45				
6(152)	PH260* 酚醛树脂轮 Phenolic Wheel	滚针轴承 Needle Roller Bearing	400	50	188	114	114	114
	PH150* 酚醛树脂轮 Phenolic Wheel	滚针轴承 Needle Roller Bearing	400	50				
	PA280* 尼龙玻纤 Nylon and Glass Fiber	6203 深沟球轴承 6203 Deep Groove Ball Bearing	330	45				
	PA230* 尼龙玻纤 Nylon and Glass Fiber	6203 深沟球轴承 6203 Deep Groove Ball Bearing	280	45				
8(203)	PH260* 酚醛树脂轮 Phenolic Wheel	滚针轴承 Needle Roller Bearing	500	50	240	152.5	152.5	152.5
	PH150* 酚醛树脂轮 Phenolic Wheel	滚针轴承 Needle Roller Bearing	500	50				
	PA280* 尼龙玻纤 Nylon and Glass Fiber	6203 深沟球轴承 6203 Deep Groove Ball Bearing	400	45				
	PA230* 尼龙玻纤 Nylon and Glass Fiber	6203 深沟球轴承 6203 Deep Groove Ball Bearing	360	45				

APPENDIX/附录

Optional Fastening Type/可选择安装方式

FASTENING TYPE FOR DS20



FASTENING TYPE FOR DS20

Top Plate/平板式

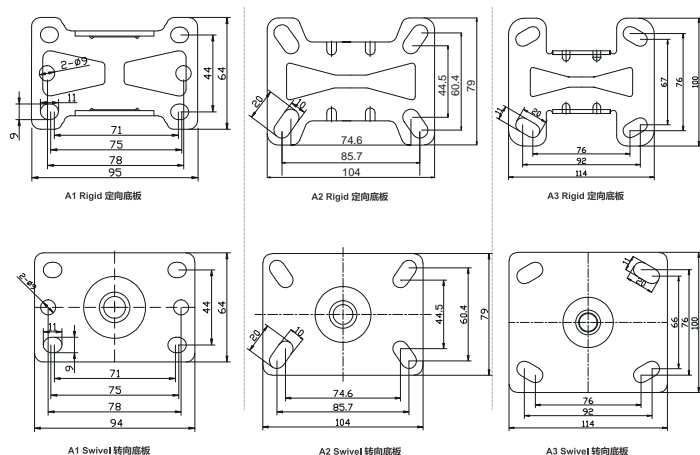

Other Fastening Type/其他安装方式

品目 Items	安装类型 Fastening Type	紧固形状 Fastening Shape	编号 NO.	规格尺寸 Size
转向 Swivel	螺栓式 Threaded Stem		B1	$\Phi 12.7 \times 13W \times 25.4 L$
			B2	$\Phi 12.7 \times 13W \times 38 L$
			B3	$\Phi 15.8 \times 11W \times 30 L$
			B4	$\Phi 12.7 \times 13W \times 50 L$
			B5	$\Phi 12.7 \times 20W \times 75 L$
			B6	$\Phi 11.1 \times 14W \times 22.2 L$
			B7	$\Phi 12.7 \times 13W \times 64 L$
			B8	$\Phi 11.1 \times 14W \times 38 L$
			B9	$\Phi 12.7 \times 13W \times 76 L$
			B10	M16 \times P1.5 \times 67 L
			B11	$\Phi 12.7 \times 13W \times 19 L$
			B12	$\Phi 12.7 \times 13W \times 25.4 L$
			B15	$\Phi 12.7 \times 13W \times 25 L$
			B16	$\Phi 15.9 \times 11W \times 38 L$
			B17	$\Phi 19 \times 10W \times 38 L$
			B18	$\Phi 19 \times 10W \times 25.4 L$
			B19	$\Phi 22.2 \times 14W \times 25.4 L$
			B20	M20 \times P2.5 \times 40 L
			转向 Swivel	四角杆式 Square Stem
卡簧杆式 Grip Ring Stem		D1		$\Phi 11 \times 38L$
		D2		$\Phi 21.4 \times 63.5L$
		D3		$\Phi 20.6 \times 55.5L$
圆柱杆式 Round Stem		E1		$\Phi 22.2 \times 53.1L_{\Phi 8Hole}$
		E2		$\Phi 25.4 \times 58 L_{\Phi 8.6 Hole}$
		E3		$\Phi 25.4 \times 71.1 L_{\Phi 10.5 Hole}$
八角杆式 Octagon Stem		F1		$\Phi 21.5 \times 62L_{\Phi 6.5 Hole}$
焊管式 Weldde Pipe Stem		G1	$\Phi 35 \times 130$	
转向 Swivel	孔质式 Hole Stem		H1	$\phi 10.2$
			H2	$\phi 12.2$

APPENDIX/附录

Optional Fastening Type/可选择安装方式

FASTENING TYPE FOR DS30

Top Plate/平板式

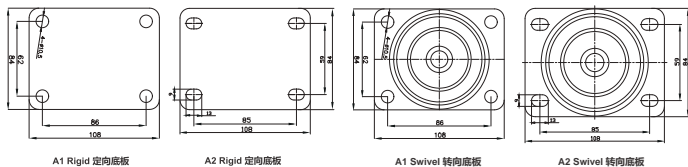

FASTENING TYPE FOR DS34

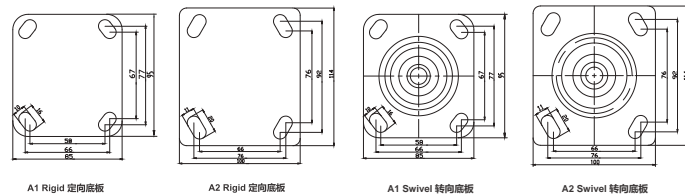

FASTENING TYPE FOR DS32

Top Plate/平板式

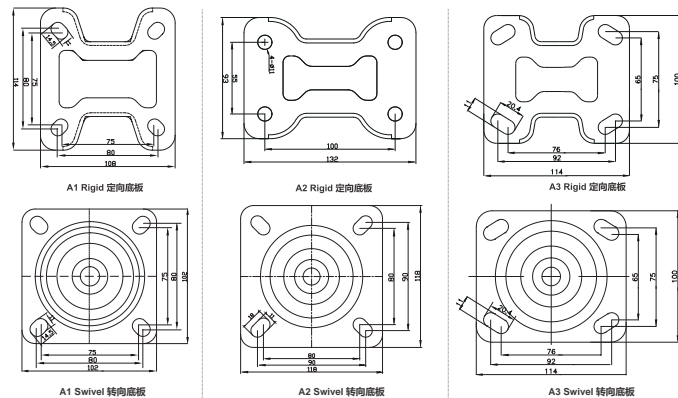

FASTENING TYPE FOR DS40/41

Other Fasteing Type/其他安装方式

品目 Items	安装类型 Fastening Type	紧固形状 Fastening Shape	编号 NO.	规格尺寸 Size
转向 Swivel	焊管式 Weldde Pipe Stem		G1	Φ35×115

APPENDIX/附录

Optional Fastening Type/可选择安装方式

FASTENING TYPE FOR DS40/41

Top Plate/平板式

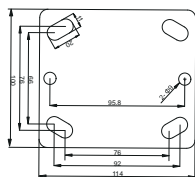

A1 Rigid 定向底板

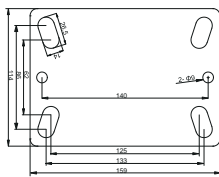

A2 Rigid 定向底板

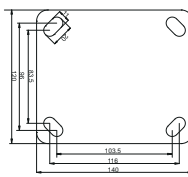

A3 Rigid 定向底板

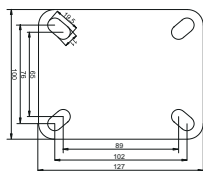

A4 Rigid 定向底板

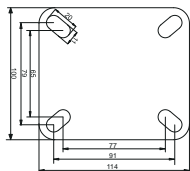

A5 Rigid 定向底板

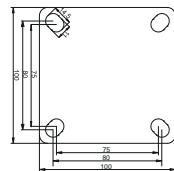

A6 Rigid 定向底板

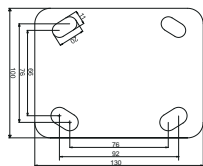

A7 Rigid 定向底板

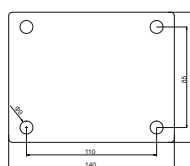

A9 Rigid 定向底板

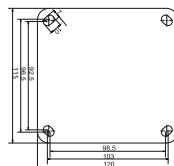

A10 Rigid 定向底板

Top Plate/平板式

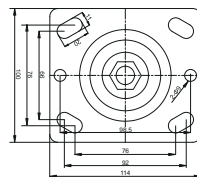

A1 Swivel 转向底板

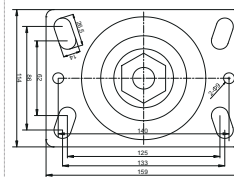

A2 Swivel 转向底板

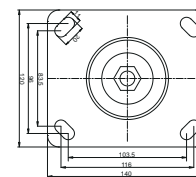

A3 Swivel 转向底板

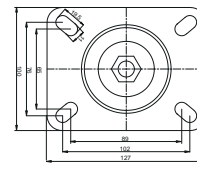

A4 Swivel 转向底板

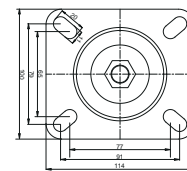

A5 Swivel 转向底板

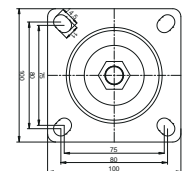

A6 Swivel 转向底板

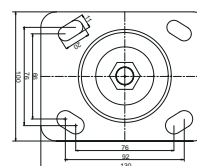

A7 Swivel 转向底板

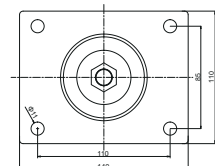

A9 Swivel 转向底板

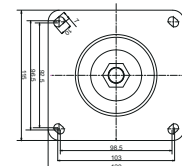

A10 Swivel 转向底板

SERVICE/服务

